



STAR® PIPE PRODUCTS

Star Pipe Products (SPP) ha fabricado y distribuido productos de hierro para la industria del agua por más de 25 años y ha crecido a más de 300 empleados. Ahora con 14 centros de distribuciones en los Estados Unidos de América y Canadá, hemos crecido a más de 1 millón de pies cuadrados de almacenamiento.

SPP tiene su sede en Houston, Texas y es una compañía registrada con ISO 9001:2000. Los laboratorios en Houston es un sitio aprobado por los organismos de certificación como UL y FM.

SPP cuenta con un equipo de más de 70 ingenieros de control de calidad, que inspeccionan los productos en las veinte fábricas aprobado por ISO 9001:2000.

PRODUCT LINES

	Size Range
C-153 Conexiones Compacto de Junta Mecánica de Hierro Dúctil	2"-64"
C-110 Conexiones Pesado de Junta Mecánica de Hierro Dúctil	2"-54"
C-153 Conexiones Compacto de Junta Tipo Empuje de Hierro Dúctil	4"-24"
C-110 Conexiones de Bridadas de Hierro Dúctil	1"-64"
C-110 Conexiones de Bridadas de Hierro Dúctil sin recubrimiento	1"-64"
Conexiones con Epoxi Fusilando (FBE)	1"-64"
Accesorios y Bridadas	2"-64"
Productos de Retención para Hierro Dúctil, PVC, Polietileno y Acero	3"-48"
Productos de AWWA C-606 Ranurado	3"-36"
Alcantarillado	Por especificaciones
Productos de Plomería (FoFo) ASTM A-74 and ASTM A-888	1½"-15"
Epoxi de Cerámica para drenaje (PROTECTO 401)	3"-64"





CENTROS DE DISTRIBUCIONES

Houston, TX	177,000 sqft.	Oficinas Corporativas
Richmond, VA	94,384 sqft.	Este Centros de Atencion al Cliente
Corona, CA	56,000 sqft.	Oeste Centros de Atencion al Cliente
Houston, TX	60,000 sqft.	
Orlando, FL	67,339 sqft.	
Seattle, WA	32,250 sqft.	
Salt Lake City, UT	15,000 sqft.	
Atlanta, GA	47,500 sqft.	
Indianapolis, IN	30,000 sqft.	
Kansas City, MO	34,000 sqft.	
Sacramento, CA	19,000 sqft.	
Phoenix, AZ	24,000 sqft.	
Montreal, CANADA	12,687 sqft.	
Cambridge, CANADA	38,700 sqft.	

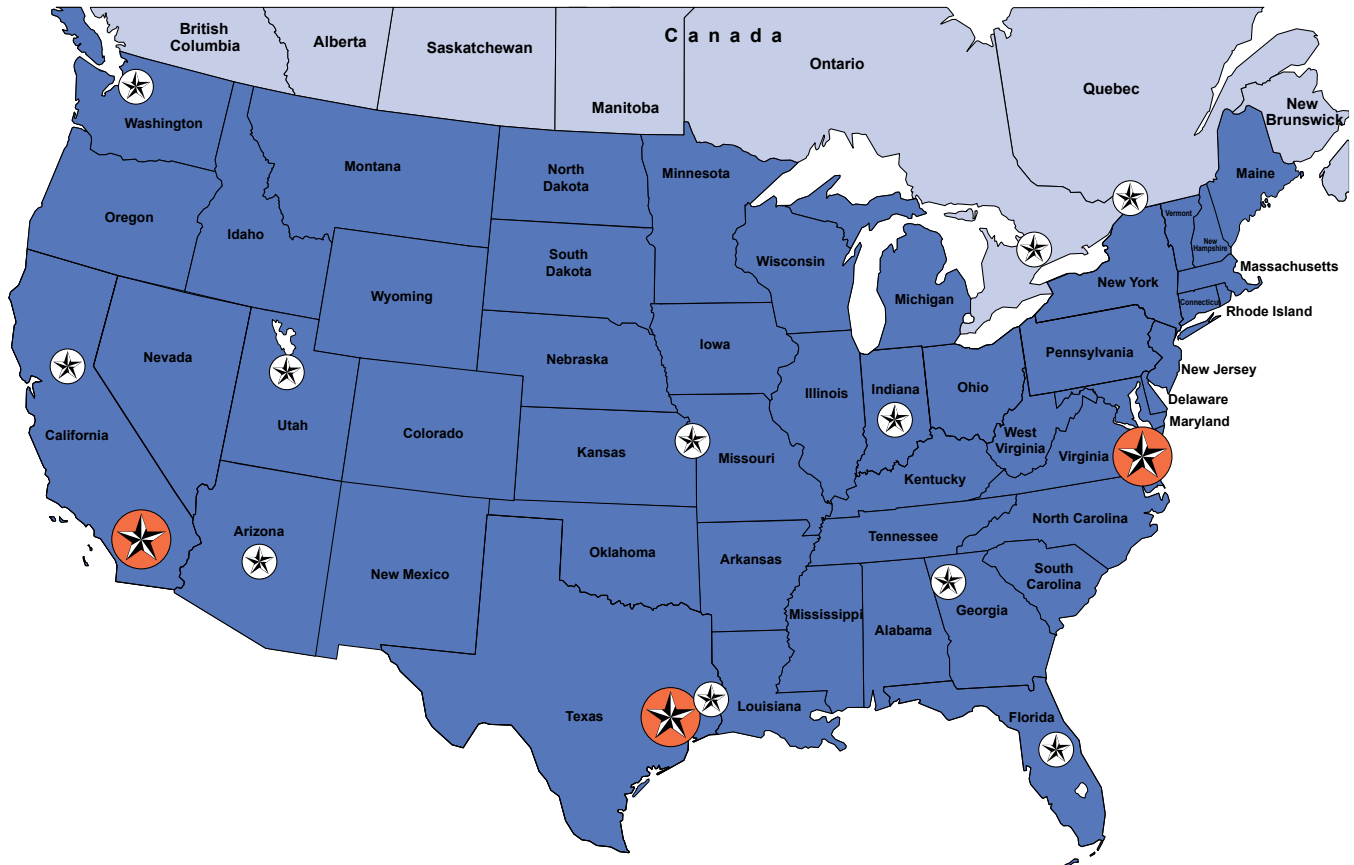



2" - 64" CONEXIONES COMPACTAS DE JUNTA MECANICA DE HIERRO DÚCTIL

ESPECIFICACIONES GENERALES

- MATERIAL:** Hierro dúctil según ASTM A536
- PRESIÓN:** 350 PSI para 3" - 24", 250 PSI para 30" - 48" y 150 PSI para 54" - 60"
- PRUEBAS:** Conforme con la norma ANSI / AWWA C153/A21.53 y los requisitos de UL y FM
- LONGITUD:** Conforme con la norma ANSI / AWWA C153/A21.53 (Piezas que no estan incluidas en las normas ANSI / AWWA estan identificado con un asterivco y son disenadas por Star Pipe Products)
- PESO:** En libras, a menos que se indique lo contrario y no incluyen los accesorios, revestimiento
- BRIDAS:** Conforme con la norma ANSI / AWWA C115/A21.15 y ANSI B16.1 clase 125 bridas
- FORRO DE CEMENTO:** Conforme con la norma ANSI / AWWA C104/A21.4
- RECUBRIMIENTO:** Pintura Bituminosa interior y exterior, conforme con la norma ANSI / AWWA C104/A21.4
- EMPAQUES:** SBR, conforme a la norma ANSI / AWWA C111/A21.11 (ver página. 17)
- TORNILLOS "T":** Acero de baja aleación de alta resistencia con recubrimiento resistente a corrosión, conforme con la norma ANSI / AWWA C111/A21.11 (ver página. 16)
- APROBACIONES:** Underwriters Laboratories (UL) 4"- 12", Factory Mutual (FM) 3"-16", y UL/NSF-61 3" y mayores
- DIMENSIONES:** Todas las dimensiones son en pulgadas a menos que se indique lo contrario

TAMBIÉN ESTÁ
DISPONIBLE EN
AWWA C110
(PESADO)

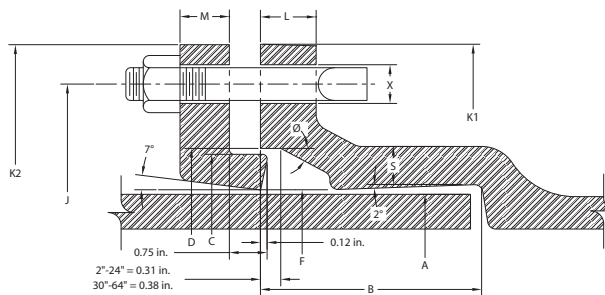

DIMENSIONES DE JUNTA MECANICA																
DIA. NOM.	A DIA.	B	C DIA.	D DIA.	F DIA.	J DIA.	K1 DIA.	K2 DIA.	L	M	S	Ø	X DIA.	TORNILLOS		
														TAMAÑOS	NO.	
★ 2	2.50	2.50	3.39	3.50	2.61	4.75	6.19	6.25	0.58	0.62	0.36	28°	3/4	5/8 x 3	2	
3	3.96	2.50	4.84	4.94	4.06	6.19	7.62	7.69	0.58	0.62	0.39	28°	3/4	5/8 x 3	4	
4	4.80	2.50	5.92	6.02	4.90	7.50	9.06	9.12	0.60	0.75	0.39	28°	7/8	3/4 x 3 1/2	4	
6	6.90	2.50	8.02	8.12	7.00	9.50	11.06	11.12	0.63	0.88	0.43	28°	7/8	3/4 x 3 1/2	6	
8	9.05	2.50	10.17	10.27	9.15	11.75	13.31	13.37	0.66	1.00	0.45	28°	7/8	3/4 x 3 1/2	6	
10	11.10	2.50	12.22	12.34	11.20	14.00	15.62	15.62	0.70	1.00	0.47	28°	7/8	3/4 x 4	8	
12	13.20	2.50	14.32	14.44	13.30	16.25	17.88	17.88	0.73	1.00	0.49	28°	7/8	3/4 x 4	8	
14	15.30	3.50	16.40	16.54	15.44	18.75	20.25	20.25	0.79	1.25	0.55	28°	7/8	3/4 x 4 1/2	10	
16	17.40	3.50	18.50	18.64	17.54	21.00	22.50	22.50	0.85	1.31	0.58	28°	7/8	3/4 x 4 1/2	12	
18	19.50	3.50	20.60	20.74	19.64	23.25	24.75	24.83	1.00	1.38	0.68	28°	7/8	3/4 x 4 1/2	12	
20	21.60	3.50	22.70	22.84	21.74	25.50	27.00	27.08	1.02	1.44	0.69	28°	7/8	3/4 x 4 1/2	14	
24	25.80	3.50	26.90	27.04	25.94	30.00	31.50	31.58	1.02	1.56	0.75	28°	7/8	3/4 x 5	16	
30	32.00	4.00	33.29	33.46	32.17	36.88	39.12	39.12	1.31	2.00	0.82	20°	1 1/8	1 x 6	20	
36	38.30	4.00	39.59	39.76	38.47	43.75	46.00	46.00	1.45	2.00	1.00	20°	1 1/8	1 x 6	24	
42	44.50	4.00	45.79	45.96	44.67	50.62	53.12	53.12	1.45	2.00	1.25	20°	1 3/8	1 1/4 x 6 1/2	28	
48	50.80	4.00	52.09	52.26	50.97	57.50	60.00	60.00	1.45	2.00	1.35	20°	1 3/8	1 1/4 x 6 1/2	32	
★ 54	{ Dimensiones disponibles bajo soliatud }															
★ 60																
★ 64																

★No Incluido en AWWA C153

STAR PIPE PRODUCTS - División América Latina

4018 Westhollow Parkway | Houston, Texas 77079
+1 281 558 3000 (tel) +1 281 558 9000 (fax)
www.starpipeproducts.com





CONEXIONES JUNTA MECANICA

ANSI/AWWA C153/A21.53

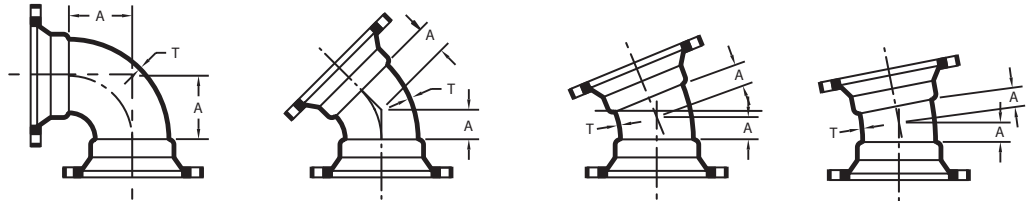

CODOS: JM x JM		CODOS 90° (1/4) JM x JM		CODOS 45° (1/8) JM x JM		CODOS 22 1/2° (1/16) JM x JM		CODOS 11 1/4° (1/32) JM x JM	
DIA. NOM.	T	A	PESO (LBS.)	A	PESO (LBS.)	A	PESO (LBS.)	A	PESO (LBS.)
★ 2	0.30	3.25	14	1.80	13	1.00	9	1.00	8
3	0.33	3.50	23	1.50	21	1.00	16	1.00	14
4	0.34	4.00	27	2.00	23	1.50	18	1.25	16
6	0.36	5.00	39	3.00	32	2.00	32	1.50	30
8	0.38	6.50	57	3.50	46	2.50	46	1.75	42
10	0.40	7.50	89	4.50	70	3.00	64	2.00	58
12	0.42	9.00	108	5.50	86	3.50	84	2.25	74
14	0.47	11.50	180	5.00	145	3.75	140	2.50	128
16	0.50	12.50	264	5.50	202	3.75	178	2.50	148
18	0.54	14.00	335	6.00	250	4.50	255	3.00	205
20	0.57	15.00	400	7.00	305	4.50	262	3.00	245
24	0.61	17.00	565	7.50	405	4.50	412	3.00	315
30	0.66	21.50	1005	11.50	798	6.75	665	4.75	606
36	0.74	24.50	1562	11.50	1164	7.75	960	5.00	840
42	0.82	29.25	2506	14.00	1792	9.00	1350	6.00	1319
48	0.90	33.25	3045	15.00	2390	10.00	1886	6.50	1700
★ 54	{ Dimensiones disponibles bajo petición }								
★ 60									
★ 64									

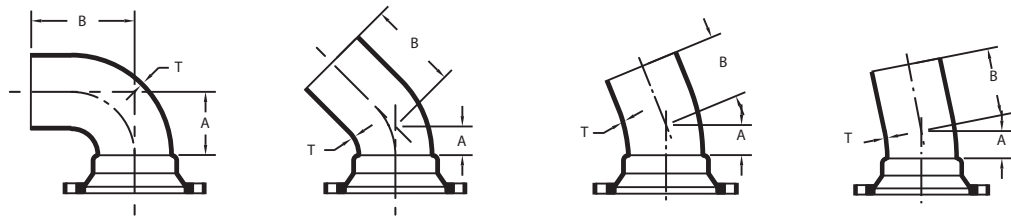

CODOS: JM x ESPIGA		CODOS 90° (1/4) JM x ESPIGA			CODOS 45° (1/8) JM x ESPIGA			CODOS 22 1/2° (1/16) JM x ESPIGA			CODOS 11 1/4° (1/32) JM x ESPIGA		
DIA. NOM.	T	A	B	PESO (LBS.)	A	B	PESO (LBS.)	A	B	PESO (LBS.)	A	B	PESO (LBS.)
3	0.33	3.50	8.50	16	1.50	7.00	13	1.00	6.50	12	1.00	6.50	12
4	0.34	4.00	9.50	22	2.00	7.50	19	1.50	7.00	18	1.25	6.25	17
6	0.36	5.00	12.00	40	3.00	8.50	31	2.00	7.50	29	1.50	7.00	27
8	0.38	6.50	12.50	61	3.50	9.00	46	2.50	8.00	43	1.75	7.25	39
10	0.40	7.50	13.00	83	4.50	10.00	68	3.00	8.50	61	2.00	7.50	52
12	0.42	9.00	14.50	114	5.50	11.00	95	3.50	9.00	81	2.25	7.75	70
14	0.47	11.50	19.50	197	5.00	13.00	148	3.75	11.25	133	2.50	10.50	122
16	0.50	12.50	20.50	248	5.50	13.50	184	3.75	11.75	166	2.50	10.50	148
18	0.54	14.00	21.00	325	6.00	13.00	235	6.00	13.00	235	6.00	13.00	235
20	0.57	15.00	22.50	390	7.00	14.00	300	7.00	14.00	300	7.00	14.00	300
24	0.61	17.00	25.00	575	7.50	14.50	390	7.50	14.50	395	7.50	14.50	400
30	0.66	22.75	31.75	865	10.50	19.50	715	6.75	15.75	600	4.75	13.75	535
36	0.74	24.50	33.50	1355	12.00	21.00	1040	7.75	16.75	865	5.00	14.00	725
42	0.82	29.25	38.25	2055	14.00	23.00	1460	9.00	18.00	1200	6.00	15.00	1030
48	0.90	33.25	42.25	2805	15.00	24.00	1905	10.00	19.00	1575	6.50	15.50	1290

★No Incluido en AWWA C153

REV.10.01

STAR PIPE PRODUCTS - División América Latina

4018 Westhollow Parkway | Houston, Texas 77079
+1 281 558 3000 (tel) +1 281 558 9000 (fax)

www.starpipeproducts.com





CONEXIONES JUNTA MECANICA
ANSI/AWWA C153/A21.53

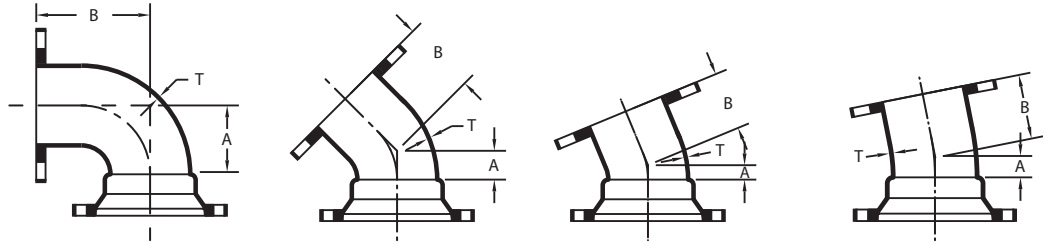

★ CODOS: JM x BRIDA		CODOS 90° (¼) JM x BRIDA			CODOS 45° (⅛) JM x BRIDA			CODOS 22 ½° (¼) JM x BRIDA			CODOS 11 ¼° (½) JM x BRIDA		
DIA. NOM.	T	A	B	PESO (LBS.)	A	B	PESO (LBS.)	A	B	PESO (LBS.)	A	B	PESO (LBS.)
3	0.33	3.50	5.50	20	1.50	3.00	17	1.00	3.00	17	1.00	3.00	15
4	0.34	4.00	6.50	26	2.00	4.00	24	1.50	4.00	26	1.25	4.00	19
6	0.36	5.00	8.00	47	3.50	5.00	40	2.00	5.00	36	1.50	5.00	30
8	0.38	6.50	9.00	68	3.50	5.50	57	2.50	5.50	53	1.75	5.50	50
10	0.40	7.50	11.00	102	4.50	6.50	83	3.00	6.50	102	2.00	6.50	75
12	0.42	9.00	12.00	134	5.50	7.50	110	3.50	7.50	134	2.25	7.50	88
14	0.47	11.50	14.00	227	5.00	7.50	207	---	---	---	---	---	---
16	0.50	12.50	15.00	306	5.50	8.00	239	---	---	---	---	---	---
30	0.66	21.50	25.00	1070	10.50	15.00	858	---	---	---	---	---	---

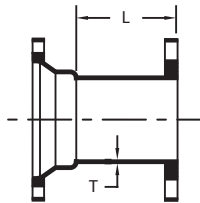

★ ADAPTADORES: JM x BRIDA			
DIA. NOM.	T	L	PESO (LBS.)
3	0.33	3.50	13
4	0.34	3.50	22
6	0.36	3.50	32
8	0.38	3.50	46
10	0.40	3.50	63
12	0.42	3.50	100
14	0.47	5.00	141
16	0.50	5.00	170
18	0.54	5.00	221
20	0.57	5.00	252
24	0.61	5.00	324
30	0.66	7.00	557
36	0.74	8.50	798
42	0.82	12.00	1214
48	0.90	12.00	1600

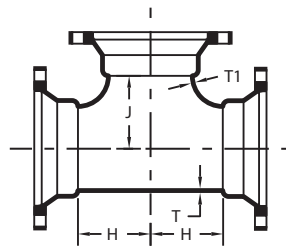

★ TEES: JM x JM					
DIA. NOM.	T	T1	H	J	PESO (LBS.)
★ 2 x 2	0.39	0.39	3.25	3.25	22
★ 3 x 2	0.48	0.39	3.50	3.50	43
3 x 3	0.33	0.33	3.00	3.00	28
4 x 3	0.34	0.33	3.50	4.00	30
4 x 4	0.34	0.34	4.00	4.00	32
6 x 3	0.36	0.33	3.50	5.00	42
6 x 4	0.36	0.34	4.00	5.00	46
★ 6 x 4 x 6	0.36	0.36	5.00	5.00	45
6 x 6	0.36	0.36	5.00	5.00	56
★ 6 x 6 x 8	0.36	0.38	6.50	6.50	62
★ 8 x 3	0.38	0.33	4.00	6.50	52
8 x 4	0.38	0.34	4.00	6.50	60
8 x 6	0.38	0.36	5.00	6.50	72
★ 8 x 6 x 6	0.38	0.38	5.00	6.50	62
★ 8 x 6 x 8	0.38	0.38	6.00	6.50	85
8 x 8	0.38	0.38	6.50	6.50	86
★ 10 x 3	0.40	0.33	4.00	7.50	75
10 x 4	0.40	0.34	4.00	7.50	78
10 x 6	0.40	0.36	5.00	7.50	90
10 x 8	0.40	0.38	6.50	7.50	105
10 x 10	0.40	0.40	7.50	7.50	120
★ 12 x 3	0.42	0.33	4.00	8.75	90
★ 12 x 4	0.42	0.34	4.00	8.75	94

(Cont.)➔





CONEXIONES JUNTA MECANICA
ANSI/AWWA C153/A21.53

TEES: JM x JM (Cont.)					
DIA. NOM.	T	T1	H	J	PESO (LBS.)
12 x 6	0.42	0.36	5.00	8.75	110
12 x 8	0.42	0.38	6.50	8.75	125
12 x 10	0.42	0.40	7.50	8.75	140
12 x 12	0.42	0.42	8.75	8.75	160
14 x 6	0.47	0.36	6.50	10.50	182
14 x 8	0.47	0.38	7.50	10.50	190
14 x 10	0.47	0.40	8.50	10.50	206
14 x 12	0.47	0.42	9.50	10.50	221
14 x 14	0.47	0.47	10.50	10.50	251
16 x 6	0.50	0.36	6.50	11.50	218
16 x 8	0.50	0.38	7.50	11.50	223
16 x 10	0.50	0.40	8.50	11.50	264
16 x 12	0.50	0.42	9.50	11.50	280
16 x 14	0.50	0.47	10.50	11.50	316
16 x 16	0.50	0.50	11.50	11.50	322
18 x 6	0.54	0.36	6.50	12.50	275
18 x 8	0.54	0.38	7.50	12.50	295
18 x 10	0.54	0.40	8.50	12.50	315
18 x 12	0.54	0.42	9.50	12.50	335
18 x 14	0.54	0.47	10.50	12.50	380
18 x 16	0.54	0.50	11.50	12.50	405
18 x 18	0.54	0.54	12.50	12.50	435
20 x 6	0.57	0.36	6.50	14.00	315
20 x 8	0.57	0.38	8.00	14.00	345
20 x 10	0.57	0.40	9.00	14.00	370
20 x 12	0.57	0.42	10.00	14.00	395
20 x 14	0.57	0.47	11.00	14.00	440
20 x 16	0.57	0.50	12.00	14.00	465
20 x 18	0.57	0.54	13.00	14.00	505
20 x 20	0.57	0.57	14.00	14.00	535
24 x 6	0.61	0.36	7.00	16.00	415
24 x 8	0.61	0.38	8.00	16.00	445
24 x 10	0.61	0.40	9.00	16.00	470
24 x 12	0.61	0.42	10.00	16.00	500
24 x 14	0.61	0.47	11.00	16.00	550
24 x 16	0.61	0.50	12.00	16.00	580
24 x 18	0.61	0.54	13.00	16.00	625
24 x 20	0.61	0.57	14.00	16.00	660
24 x 24	0.61	0.61	16.00	16.00	720
★ 30 x 6	0.66	0.36	8.00	20.00	686
30 x 8	0.66	0.38	8.50	20.00	739
30 x 12	0.66	0.42	10.00	20.00	830
★ 30 x 14	0.66	0.47	11.00	20.00	880
★ 30 x 16	0.66	0.50	12.50	20.00	959
★ 30 x 18	0.66	0.54	14.00	20.00	1085
30 x 20	0.66	0.57	15.00	20.00	1000
30 x 24	0.66	0.61	21.00	22.00	1389
30 x 30	0.66	0.66	20.00	20.00	1323
★ 36 x 6	0.74	0.36	8.00	23.50	1100
★ 36 x 8	0.74	0.38	9.00	23.50	1287
36 x 12	0.74	0.42	10.00	23.50	1150
★ 36 x 16	0.74	0.50	12.50	23.50	1165
★ 36 x 18	0.74	0.54	13.00	23.50	1410

(Cont.)➔

TEES: JM x JM (Cont.)					
DIA. NOM.	T	T1	H	J	PESO (LBS.)
★ 36 x 20	0.74	0.57	15.00	23.50	1650
36 x 24	0.74	0.61	16.00	23.50	1550
36 x 30	0.74	0.66	26.00	26.00	2381
36 x 36	0.74	0.74	23.50	23.50	2072
★ 42 x 6	0.82	0.36	9.00	27.50	1600
★ 42 x 12	0.82	0.42	14.00	27.50	1950
★ 42 x 16	0.82	0.50	13.00	27.50	2040
★ 42 x 18	0.82	0.54	16.00	27.50	2195
42 x 24	0.82	0.61	20.00	27.50	2270
42 x 30	0.82	0.66	22.00	29.50	2608
42 x 36	0.82	0.74	30.00	30.00	3000
42 x 42	0.82	0.82	30.00	30.00	3175
★ 48 x 6	0.90	0.36	10.00	32.00	2155
★ 48 x 12	0.90	0.42	14.00	32.00	2500
★ 48 x 16	0.90	0.50	13.00	32.00	2405
48 x 24	0.90	0.61	23.00	32.00	2870
48 x 30	0.90	0.66	23.00	32.00	3050
48 x 36	0.90	0.74	33.50	32.25	3900
48 x 42	0.90	0.82	33.50	33.50	4100
48 x 48	0.90	0.90	33.50	33.50	4250
★ 54 x 20	{ Dimensiones disponibles bajo petición }				
★ 64 x 64					

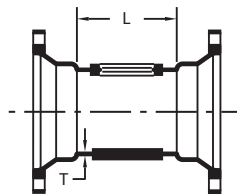

★ TEES CON ROSCA: JM x JM (ROSCA DE 2")				
DIA. NOM.	T	L	MAX ROSCA	PESO (LBS.)
3	0.33	6.00	2 ½	18
4	0.34	6.00	3	25
6	0.36	6.00	3	35
8	0.38	6.00	3	55
10	0.40	6.00	3	70
12	0.42	6.00	3	85
16	0.50	6.00	3	164

Rosca conforme a ANSI/ASME B1.20.1





CONEXIONES JUNTA MECANICA
ANSI/AWWA C153/A21.53

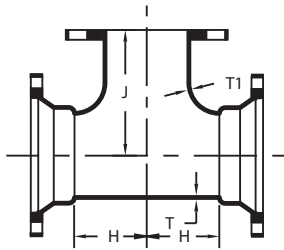

★ **TEES: JM x BRIDA**

DIA. NOM.	T	T1	H	J	PESO (LBS.)
3 x 3	0.33	0.33	3.00	5.50	30
4 x 2	0.52	0.39	4.80	4.80	53
4 x 3	0.34	0.33	3.50	6.50	34
4 x 4	0.34	0.34	4.00	6.50	40
6 x 3	0.36	0.33	3.50	8.00	50
6 x 4	0.36	0.34	4.00	8.00	65
6 x 6	0.36	0.36	5.00	8.00	62
8 x 4	0.38	0.34	4.50	9.00	75
8 x 6	0.38	0.36	5.50	9.00	78
8 x 8	0.38	0.38	6.50	9.00	88
10 x 4	0.40	0.34	4.00	11.00	90
10 x 6	0.40	0.36	5.00	11.00	106
10 x 8	0.40	0.38	6.50	11.00	114
10 x 10	0.40	0.40	7.50	11.00	126
12 x 4	0.42	0.34	4.50	12.00	118
12 x 6	0.42	0.36	5.50	12.00	133
12 x 8	0.42	0.38	6.50	12.00	134
12 x 10	0.42	0.40	7.50	12.00	145
12 x 12	0.42	0.42	8.75	12.00	170
14 x 6	0.47	0.36	6.50	14.00	185
14 x 10	0.47	0.40	8.50	14.00	244
14 x 12	0.47	0.42	9.50	14.00	284
14 x 14	0.47	0.47	10.50	14.00	305
16 x 6	0.50	0.36	6.50	15.00	207
16 x 8	0.50	0.38	7.50	15.00	260
16 x 10	0.50	0.40	8.50	15.00	287
16 x 12	0.50	0.42	9.50	15.00	312
16 x 14	0.50	0.47	10.50	15.00	348
16 x 16	0.50	0.50	11.50	15.00	374
18 x 6	0.54	0.36	6.50	15.50	325
18 x 8	0.54	0.38	7.50	15.50	351
18 x 12	0.54	0.42	9.50	15.50	358
18 x 18	0.54	0.54	12.50	16.50	445
20 x 6	0.57	0.36	6.50	17.00	360
20 x 8	0.57	0.38	8.00	17.00	339
24 x 6	0.61	0.36	7.00	19.00	406
24 x 8	0.61	0.38	8.00	19.00	472
24 x 12	0.61	0.42	10.00	19.00	580
24 x 16	0.61	0.50	12.00	19.00	744
24 x 24	0.61	0.61	16.00	22.00	950
30 x 6	0.66	0.36	8.00	23.00	675
30 x 8	0.66	0.38	8.50	23.00	695
30 x 12	0.66	0.42	10.00	23.00	715
30 x 16	0.66	0.50	12.50	23.00	1125

(Conf.)➔

★ **TEES: JM x BRIDA (Cont.)**

DIA. NOM.	T	T1	H	J	PESO (LBS.)
30 x 24	0.66	0.61	16.00	25.00	1290
36 x 6	0.74	0.36	8.00	26.00	1175
36 x 16	0.74	0.50	12.50	26.00	1475

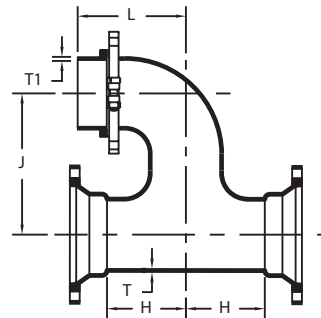

★ **TEE PARALELO: JM x ES LABON GIRATORIO (SWIVEL)**

DIA. NOM.	T	T1	H	J	L	PESO (LBS.)
6 x 6	0.36	0.36	8.00	12.50	10.00	83
8 x 6	0.38	0.36	9.00	13.50	11.00	105
10 x 6	0.40	0.38	11.00	14.00	13.00	125

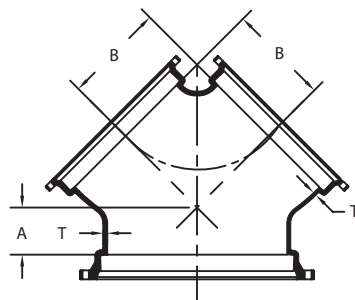

★ **"Y" 90° JM**

DIA. NOM.	T	T1	A	B	PESO (LBS.)
24 x 14	0.61	0.47	9.00	11.50	395
30 x 24	0.66	0.61	8.00	17.00	815

★No Incluido en AWWA C153

REV.10.01

STAR PIPE PRODUCTS - División América Latina

4018 Westhollow Parkway | Houston, Texas 77079
+1 281 558 3000 (tel) +1 281 558 9000 (fax)

www.starpipeproducts.com





CONEXIONES JUNTA MECANICA
ANSI/AWWA C153/A21.53

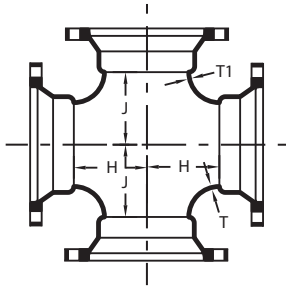

CRUCES: JM

DIA. NOM.	T	T1	H	J	PESO (LBS.)
3 x 3	0.33	0.33	3.00	3.00	35
4 x 3	0.34	0.33	3.50	4.00	38
4 x 4	0.34	0.34	4.00	4.00	40
6 x 4	0.36	0.34	4.00	5.00	68
6 x 6	0.36	0.36	5.00	5.00	80
8 x 4	0.38	0.34	4.00	6.00	99
8 x 6	0.38	0.36	5.00	6.00	100
8 x 8	0.38	0.38	6.00	6.00	106
10 x 4	0.40	0.34	4.00	7.00	120
10 x 6	0.40	0.36	5.00	7.00	125
10 x 8	0.40	0.38	6.50	7.00	130
10 x 10	0.40	0.40	7.00	7.00	145
12 x 4	0.42	0.34	4.00	8.50	123
12 x 6	0.42	0.36	5.00	8.50	142
12 x 8	0.42	0.38	6.00	8.50	157
12 x 10	0.42	0.40	7.50	8.50	189
12 x 12	0.42	0.42	8.50	8.50	200
14 x 6	0.47	0.36	6.50	10.50	210
14 x 8	0.47	0.38	7.50	10.50	231
14 x 10	0.47	0.40	8.50	10.50	255
14 x 12	0.47	0.42	9.50	10.50	269
14 x 14	0.47	0.47	10.50	10.50	335
16 x 6	0.50	0.36	6.50	11.50	250
16 x 8	0.50	0.38	7.50	11.50	264
16 x 10	0.50	0.40	8.50	11.50	286
16 x 12	0.50	0.42	9.50	11.50	310
16 x 16	0.50	0.50	11.50	11.50	385
18 x 12	0.54	0.42	9.50	12.50	348
18 x 18	0.54	0.54	12.50	12.50	478
20 x 8	0.57	0.38	8.00	14.00	379
20 x 12	0.57	0.42	10.00	14.00	413
20 x 18	0.57	0.54	13.00	14.00	554
20 x 20	0.57	0.57	14.00	14.00	590
24 x 6	0.61	0.36	7.00	16.00	481
24 x 8	0.61	0.38	8.00	16.00	500
24 x 12	0.61	0.42	10.00	16.00	529
24 x 16	0.61	0.50	12.00	16.00	576
24 x 18	0.61	0.54	13.00	16.00	868
24 x 20	0.61	0.57	14.00	16.00	1015
24 x 24	0.61	0.61	16.00	16.00	881
30 x 12	0.66	0.42	10.00	20.00	870
30 x 24	0.66	0.61	16.00	20.00	1333
30 x 30	0.66	0.66	22.00	22.00	1691
36 x 24	0.74	0.61	16.00	23.50	1840

(Cont.)➔

CRUCES: JM (Cont.)

DIA. NOM.	T	T1	H	J	PESO (LBS.)
36 x 36	0.74	0.74	26.00	26.00	2811
42 x 24	0.82	0.61	20.00	27.50	2480
42 x 36	0.82	0.74	30.00	30.00	3900
48 x 24	0.90	0.61	23.00	32.00	3670
48 x 30	0.90	0.66	23.00	32.00	4505
48 x 36	0.90	0.74	33.50	32.25	4700

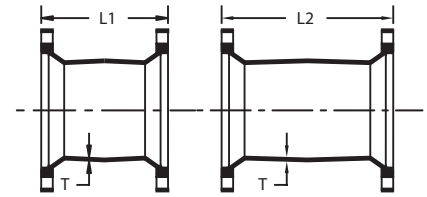

CARRETES / COPLES JM

DIA. NOM.	T	CARRETE CORTO		CARRETE LARGO	
		L1	PESO (LBS.)	L2	PESO (LBS.)
2	0.30	7.50	8	12.00	13
3	0.33	7.50	13	12.00	18
4	0.34	7.50	17	12.00	20
6	0.36	7.50	28	12.00	36
8	0.38	7.50	38	12.00	46
10	0.40	7.50	49	12.00	62
12	0.42	7.50	56	12.00	76
14	0.47	9.50	93	15.00	125
16	0.50	9.50	108	15.00	172
18	0.54	9.00	160	15.00	225
20	0.57	9.00	195	15.00	255
24	0.61	9.00	255	15.00	335
30	0.66	15.00	500	24.00	670
36	0.74	15.00	725	24.00	1091
42	0.82	15.00	877	24.00	1390
48	0.90	15.00	1406	24.00	1740

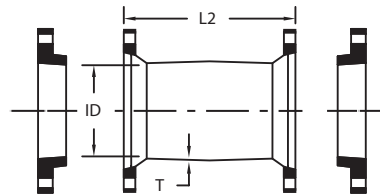

DOBLE USO CARRETES JM CON CONTRABRIDAS GRANDES

DIA. NOM.	TAMAÑOS (DO DE TUBO)	T	L	(I.D.)	PESO (LBS.)
4	4.80 - 5.00	0.34	12.00	5.10	20
6	6.90 - 7.10	0.36	12.00	7.20	36
8	9.05 - 9.30	0.38	12.00	9.40	46
10	11.10 - 11.40	0.40	12.00	11.50	62
12	13.20 - 13.50	0.42	12.00	13.60	76
16	17.40 - 17.80	0.50	15.00	17.94	172



★No Incluido en AWWA C153

STAR PIPE PRODUCTS - División América Latina

4018 Westhollow Parkway | Houston, Texas 77079
+1 281 558 3000 (tel) +1 281 558 9000 (fax)
www.starpipeproducts.com



CONEXIONES JUNTA MECANICA
ANSI/AWWA C153/A21.53

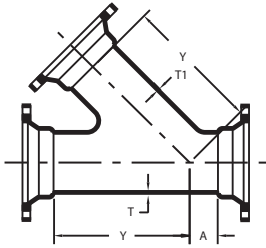

★ **"Y" LATERALES 45° JM**

DIA. NOM.	T	T1	A	Y	PESO (LBS.)
3 x 3	0.33	0.33	2.50	8.50	36
4 x 3	0.34	0.33	2.50	8.50	40
4 x 4	0.34	0.34	2.50	8.50	41
6 x 4	0.36	0.34	1.50	11.00	53
6 x 6	0.36	0.36	3.00	12.50	85
8 x 4	0.38	0.34	0.50	13.00	73
8 x 6	0.38	0.36	2.00	14.50	90
8 x 8	0.38	0.38	3.50	16.00	102
10 x 4	0.40	0.34	0.00	15.00	150
10 x 6	0.40	0.36	1.00	16.00	158
10 x 8	0.40	0.38	2.50	17.00	172
10 x 10	0.40	0.40	3.50	19.00	210
12 x 4	0.42	0.34	0.00	16.50	184
12 x 6	0.42	0.36	1.50	18.50	186
12 x 8	0.42	0.38	1.50	18.50	188
12 x 10	0.42	0.40	3.00	20.00	250
12 x 12	0.42	0.42	4.50	22.50	272
14 x 14	0.47	0.47	6.00	25.00	474
16 x 6	0.50	0.36	0.00	21.00	300
16 x 8	0.50	0.38	0.50	22.50	349
16 x 12	0.50	0.42	3.50	25.00	453
16 x 16	0.50	0.50	6.50	28.00	575

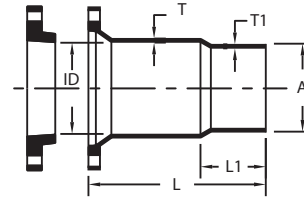

★ **CARRETES JM x ESPIGA CON CONTRABRIDAS GRANDES**

DIA. NOM.	ID	T	T1	A	L	L1	PESO (LBS.)
4	5.10	0.36	0.34	4.80	20.00	9.00	50
6	7.20	0.38	0.36	6.90	20.00	9.00	62
8	9.40	0.40	0.38	9.05	20.00	9.00	90
10	11.50	0.42	0.40	11.10	20.00	9.00	105
12	13.60	0.47	0.42	13.20	20.00	9.00	128
16	17.90	0.54	0.50	17.40	20.00	9.00	275

TAPAS HEMBRA

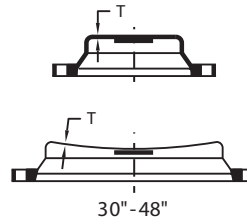

TAPAS MACHO

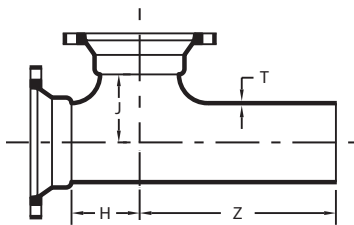
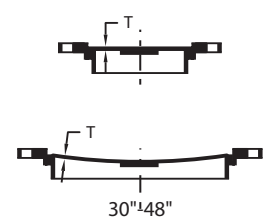

★ **TEES: JM x ESPIGA x JM**

DIA. NOM.	T	H	J	Z	PESO (LBS.)
6 x 6	0.36	5.00	5.00	12.00	57
8 x 6	0.38	5.50	6.50	11.50	69
8 x 8	0.38	6.50	6.50	12.50	77
10 x 10	0.40	7.50	7.50	13.00	120

TAPAS JM HEMBRA Y MACHO (CIEGA O ROSCA)

DIA. NOM.	T	ROSCA MAX.	PESO (LBS.)	
			TAPAS MACHO	TAPAS HEMBRA
3	0.48	2	9	8
4	0.34	2	12	9
6	0.42	2	21	15
8	0.44	2	32	22
10	0.46	2	40	32
12	0.48	2	54	42
14	0.55	2 ½	77	86
16	0.56	2 ½	101	94
18	0.60	3	126	116
20	0.66	3	139	129
24	0.68	3	181	171
30	0.82	4	434	395
36	1.00	4	688	628
42	1.00	4	1200	893
48	1.00	4	1550	1076

Rosca conforme a ANSI/ASME B1.20.1





CONEXIONES JUNTA MECANICA
ANSI/AWWA C153/A21.53

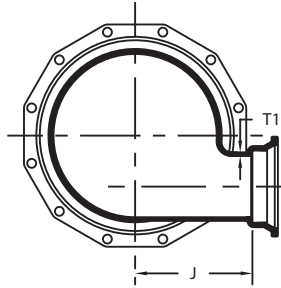
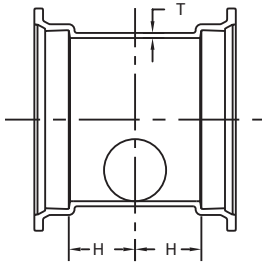

★ TEE: SALIDA TANGENCIAL JM x JM					
DIA. NOM.	T	T1	H	J	PESO (LBS.)
16 x 6	0.50	0.38	6.50	11.50	225
16 x 12	0.50	0.42	9.50	11.50	300
18 x 6	0.54	0.36	6.50	12.50	285
24 x 6	0.61	0.36	7.00	16.00	455
24 x 12	0.61	0.42	10.00	16.00	540

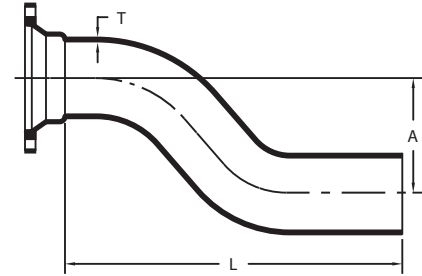
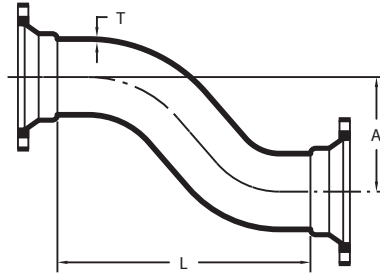

★ DESVIACIONES			JM x JM		JM x ESPIGA	
DIA. NOM.	T	A	L	PESO (LBS.)	L	PESO (LBS.)
3 x 6	0.33	6.00	9.00	20	---	---
4 x 6	0.34	6.00	10.00	25	15.50	25
4 x 12	0.34	12.00	18.00	55	23.50	46
4 x 18	0.34	18.00	22.00	65	27.50	59
4 x 24	0.34	24.00	28.00	75	33.50	65
6 x 6	0.36	6.00	12.00	29	17.50	51
6 x 12	0.36	12.00	18.00	69	23.50	68
6 x 18	0.36	18.00	24.00	87	29.50	96
6 x 24	0.36	24.00	30.00	107	35.50	117
8 x 6	0.38	6.00	13.00	80	18.50	78
8 x 12	0.38	12.00	19.00	105	24.50	110
8 x 18	0.38	18.00	25.00	135	30.50	124
8 x 24	0.38	24.00	30.00	141	35.50	189
10 x 6	0.40	6.00	15.00	110	20.50	130
10 x 12	0.40	12.00	21.00	135	26.50	172
10 x 18	0.40	18.00	27.00	183	32.50	189
10 x 24	0.40	24.00	33.00	175	38.50	237
12 x 6	0.42	6.00	17.00	118	22.50	115
12 x 12	0.42	12.00	23.00	203	28.50	198
12 x 18	0.42	18.00	27.00	190	32.50	270
12 x 24	0.42	24.00	35.00	277	40.50	334
16 x 12	0.50	12.00	26.00	206	---	---
16 x 18	0.50	18.00	36.00	250	---	---





CONEXIONES JUNTA MECANICA
ANSI/AWWA C153/A21.53

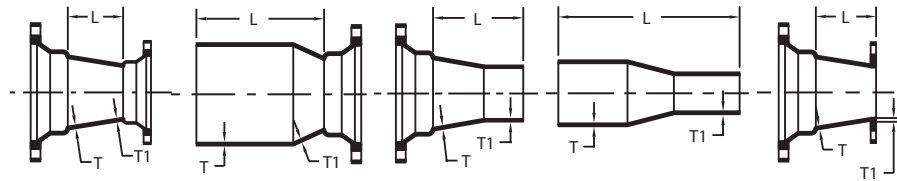

REDUCCIONES			JM x JM		JM CHICA		JM GRANDE		ESPIGA x ESPIGA		JM x BRIDA	
DIA. NOM.	T	T1	L	PESO (LBS.)	L	PESO (LBS.)	L	PESO (LBS.)	L	PESO (LBS.)	L	PESO (LBS.)
4 x 3	0.34	0.33	3.00	18	8.50	17	8.50	18	14.00	14	5.00	19.00
6 x 3	0.36	0.33	5.00	22	10.62	24	10.50	19	16.00	19	---	---
6 x 4	0.36	0.34	4.00	24	9.50	23	9.50	23	15.00	22	5.00	30.00
8 x 4	0.38	0.34	5.00	32	10.50	30	10.50	34	16.00	30	---	---
8 x 6	0.38	0.36	4.00	36	9.50	35	9.50	32	15.00	33	6.00	41.00
10 x 4	0.40	0.34	7.00	46	12.50	44	12.50	43	---	---	---	---
10 x 6	0.40	0.36	5.00	47	10.50	46	10.50	46	16.00	46	---	---
10 x 8	0.40	0.38	4.00	50	9.50	49	9.50	50	15.00	47	---	---
12 x 4	0.42	0.34	9.00	58	14.50	60	14.50	57	20.00	58	---	---
12 x 6	0.42	0.36	7.00	60	12.50	53	12.50	57	18.00	57	---	---
12 x 8	0.42	0.38	5.00	60	10.50	61	10.50	59	16.00	54	7.00	82
12 x 10	0.42	0.40	4.00	64	9.50	53	9.50	58	15.00	54	---	---
14 x 6	0.47	0.36	9.00	110	16.90	100	14.50	105	---	---	---	---
14 x 8	0.47	0.38	7.00	122	14.90	99	12.40	98	---	---	---	---
14 x 10	0.47	0.40	5.00	120	12.90	96	10.40	92	---	---	---	---
14 x 12	0.47	0.42	4.00	132	11.90	90	9.40	92	17.30	88	---	---
16 x 6	0.50	0.36	11.00	148	21.00	125	16.50	144	24.30	93	---	---
16 x 8	0.50	0.38	9.00	155	18.00	124	14.50	136	22.30	119	---	---
16 x 10	0.50	0.40	7.00	160	15.00	124	12.50	125	20.50	119	---	---
16 x 12	0.50	0.42	5.00	161	12.90	122	10.50	116	18.30	99	---	---
16 x 14	0.50	0.47	4.00	173	12.00	133	12.00	135	19.70	129	---	---
18 x 8	0.54	0.38	13.00	201	20.00	170	19.50	195	---	---	16.00	190
18 x 10	0.54	0.40	10.00	196	18.00	165	17.40	185	25.50	160	---	---
18 x 12	0.54	0.42	7.00	180	15.50	150	14.00	150	19.50	150	12.00	198
18 x 14	0.54	0.47	6.00	200	15.00	175	15.00	200	---	---	---	---
18 x 16	0.54	0.50	5.00	196	12.50	170	12.50	192	---	---	---	---
★ 20 x 8	0.57	0.38	16.00	227	---	---	---	---	---	---	---	---
20 x 10	0.57	0.40	16.00	220	22.12	200	19.00	210	---	---	---	---
20 x 12	0.57	0.42	12.00	227	17.50	170	16.00	205	---	---	---	---
20 x 14	0.57	0.47	10.00	200	18.00	190	17.90	205	---	---	---	---
20 x 16	0.57	0.50	7.00	231	13.50	185	13.50	200	---	---	---	---
20 x 18	0.57	0.54	4.00	225	12.00	200	12.00	215	---	---	---	---
★ 24 x 8	0.61	0.38	20.00	263	---	---	---	---	---	---	---	---
24 x 12	0.61	0.42	16.00	263	21.50	275	21.00	290	---	---	18.00	318
24 x 14	0.61	0.47	14.00	310	22.00	310	21.90	315	---	---	---	---
24 x 16	0.61	0.50	13.00	279	21.00	285	17.50	285	---	---	---	---
24 x 18	0.61	0.54	10.00	284	18.00	300	18.00	310	---	---	---	---
24 x 20	0.61	0.57	7.00	328	15.00	276	13.50	275	---	---	---	---
★ 30 x 12	0.66	0.42	30.00	763	---	---	---	---	---	---	---	---
30 x 16	0.66	0.50	30.00	633	39.00	565	39.00	623	48.00	690	---	---
30 x 18	0.66	0.54	28.00	658	37.00	654	37.00	635	---	---	---	---
30 x 20	0.66	0.57	24.00	628	33.00	590	33.00	603	---	---	---	---
30 x 24	0.66	0.61	10.00	478	24.50	536	24.50	526	---	---	---	---
★ 36 x 12	0.74	0.42	36.00	1135	---	---	---	---	---	---	---	---

(Cont.)➔



★No Incluido en AWWA C153

STAR PIPE PRODUCTS - División América Latina

4018 Westhollow Parkway | Houston, Texas 77079
+1 281 558 3000 (tel) +1 281 558 9000 (fax)
www.starpipeproducts.com



(Cont. de la página anterior)

REDUCCIONES			JM x JM		JM CHICA		JM GRANDE		ESPIGA x ESPIGA		JM x BRIDA	
DIA. NOM.	T	T1	L	PESO (LBS.)	L	PESO (LBS.)	L	PESO (LBS.)	L	PESO (LBS.)	L	PESO (LBS.)
★ 36 x 16	0.74	0.50	40.00	1078	27.00	700	---	---	---	---	---	---
★ 36 x 18	0.74	0.54	38.00	1329	37.00	800	---	---	---	---	---	---
★ 36 x 20	0.74	0.57	36.00	1165	45.00	850	45.00	950	---	---	---	---
36 x 24	0.74	0.61	19.00	822	33.12	746	33.00	810	---	---	---	---
36 x 30	0.74	0.66	15.50	650	24.62	788	24.50	758	---	---	---	---
42 x 24	0.82	0.61	40.00	1356	49.00	1204	49.00	1320	---	---	---	---
42 x 30	0.82	0.66	20.00	1083	29.12	1150	29.00	1015	---	---	---	---
42 x 36	0.82	0.74	15.50	1114	24.62	962	24.50	1013	---	---	---	---
★ 48 x 24	0.90	0.61	40.00	1700	---	---	---	---	---	---	---	---
48 x 30	0.90	0.66	40.00	1779	49.00	1594	49.00	1711	---	---	---	---
48 x 36	0.90	0.74	28.00	1641	37.00	1456	37.00	1540	---	---	---	---
48 x 42	0.90	0.82	15.50	1426	24.50	1241	24.50	1275	---	---	---	---
★ 54 x 36 60 x 48	{ Dimensiones disponibles bajo solitud }											

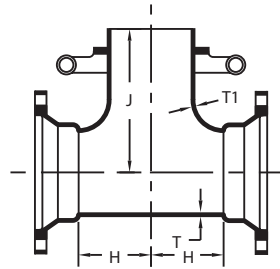
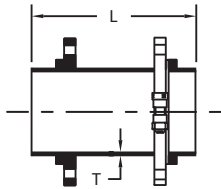

★ **ADAPTADORES HIDRANTES: SOLIDA x ESLABON GIRATORIO (SWIVEL)**

DIA. NOM.	T	L	PESO (LBS.)
4 x 13	0.34	13.00	29
6 x 13	0.36	11.50	47
6 x 18	0.36	18.00	56
6 x 24	0.36	24.00	60
6 x 36	0.36	36.00	75
6 x 48	0.36	48.00	94
8 x 13	0.38	13.00	54
8 x 18	0.38	18.00	67
8 x 24	0.38	24.00	82
8 x 48	0.38	48.00	143
12 x 13	0.42	13.00	120

★ **TEE HIDRANTE: JM x ESLABON GIRATORIO (SWIVEL)**

DIA. NOM.	T	T1	H	J	PESO (LBS.)
6 x 6	0.36	0.36	5.00	10.25	65
8 x 6	0.38	0.36	5.00	11.25	85
8 x 8	0.38	0.38	6.50	11.50	100
10 x 6	0.40	0.36	5.00	12.75	105
10 x 8	0.40	0.38	6.50	12.75	118
12 x 6	0.42	0.36	5.00	13.75	126
12 x 8	0.42	0.38	6.50	13.75	128
14 x 6	0.47	0.36	6.50	15.00	211
16 x 6	0.50	0.36	6.50	16.00	279
18 x 6	0.54	0.36	6.50	18.00	278
20 x 6	0.57	0.36	6.50	18.50	358
24 x 6	0.61	0.36	7.00	19.00	460



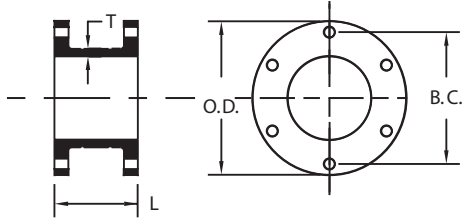

Material: Fundición de hierro gris según ASTM A 48
Extensiones incluye dos (2) ranuras de ruptura

★ **EXTENSIONES PARA HIDRANTES (6 AGUJEROS ESTANDAR)**

DIA. NOM.	T	DIMENSIONES			DIA. AGUJERO	PESO (LBS.)
		L	B.C.	O.D.		
6 x 6	0.56	6.00	9.50	11.12	0.75	50
6 x 12	0.56	12.00	9.50	11.12	0.75	73

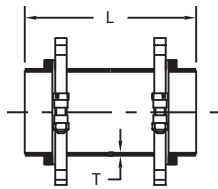

★ **ADAPTADORES HIDRANTES: ESLABON GIRATORIO x ESLABON GIRATORIO (SWIVEL x SWIVEL)**

DIA. NOM.	T	L	PESO (LBS.)
6 x 12	0.36	12.00	28
6 x 18	0.36	18.00	49
6 x 24	0.36	24.00	52

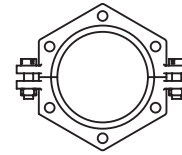

★ **CONTRABRIDAS PARA SWIVEL**

DIA. NOM.	PESO (LBS.)
4	8
6	12
8	10
12	24

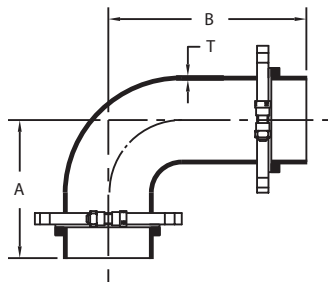

★ **CODO HIDRANTES: ESLABON GIRATORIO x ESLABON GIRATORIO (SWIVEL x SWIVEL)**

DIA. NOM.	T	A	B	PESO (LBS.)
6	0.36	10.50	16.00	50





CONEXIONES JUNTA MECANICA
ANSI/AWWA C153/A21.53

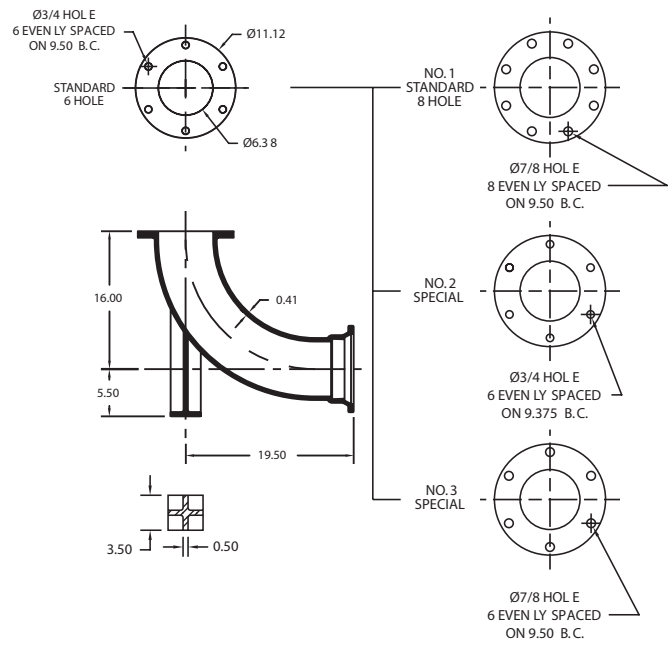
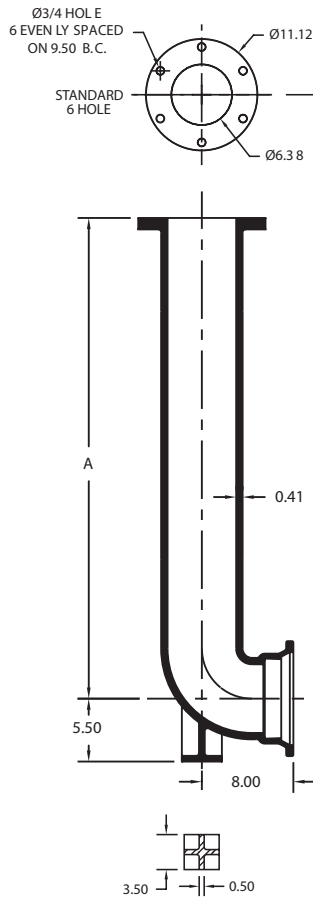

★ **BURY HIDRANTES: JM**

DIA. NOM.	A	PESO (LBS.)
6 x 22	22.00	85
6 x 24	24.00	90
6 x 30	30.00	103
6 x 36	36.00	117
6 x 42	42.00	130
6 x 48	48.00	146
6 x 54	54.00	160

★ **BURY HIDRANTES: JM RADIO LARGO**

DIA. NOM.	RADIUS	PESO (LBS.)
6	15.00	84





CONEXIONES JUNTA MECANICA
ANSI/AWWA C153/A21.53

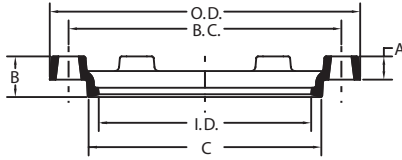

★ **CONTRABRIDAS PARA JUNTA MECANICA**

DIA. NOM.	O.D.	A	B	C	I.D.	B.C.	AGUJERO	CANT. TORNILLOS	PESO (LBS.)
2	6.12	0.62	1.12	3.40	2.61	4.75	Ø0.75	2	1
3	7.69	0.62	1.37	4.84	4.06	6.19	Ø0.75	4	2
4	9.12	0.75	1.50	5.92	4.90	7.50	Ø0.88	4	3
6	11.12	0.88	1.63	8.02	7.00	9.50	Ø0.88	6	5
8	13.37	1.00	1.75	10.17	9.15	11.75	Ø0.88	6	6
10	15.62	1.00	1.75	12.22	11.20	14.00	Ø0.88	8	8
12	17.88	1.00	1.75	14.32	13.30	16.25	Ø0.88	8	9
14	20.25	1.25	2.00	16.40	15.44	18.75	Ø0.88	10	13
16	22.50	1.31	2.06	18.50	17.54	21.00	Ø0.88	12	17
18	24.83	1.38	2.13	20.60	19.64	23.25	Ø0.88	12	30
20	27.08	1.44	2.19	22.70	21.74	25.50	Ø0.88	14	35
24	31.58	1.56	2.31	26.90	25.94	30.00	Ø0.88	16	50
30	39.12	2.00	2.75	33.29	32.17	36.88	Ø1.13	20	85
36	46.00	2.00	2.75	39.59	38.47	43.75	Ø1.13	24	115
42	53.12	2.00	2.75	45.79	44.67	50.62	Ø1.38	28	143
48	60.00	2.00	2.75	52.09	50.97	57.50	Ø1.38	32	237
54	{ Dimensiones disponibles bajo soliatud }								
60									
64									

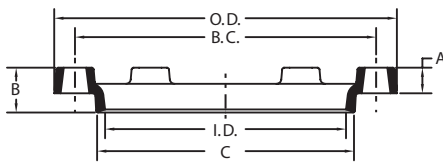

★ **CONTRABRIDAS GRANDES PARA JUNTA MECANICA**

DIA. NOM.	O.D.	A	B	C	I.D.	B.C.	AGUJERO	CANT. TORNILLOS	PESO (LBS.)
4	9.12	0.75	1.50	5.92	5.10	7.50	Ø0.88	4	3
6	11.12	0.88	1.63	8.02	7.20	9.50	Ø0.88	6	5
8	13.37	1.00	1.75	10.17	9.40	11.75	Ø0.88	6	6
10	15.62	1.00	1.75	12.22	11.50	14.00	Ø0.88	8	8
12	17.88	1.00	1.75	14.32	13.60	16.25	Ø0.88	8	9
16	22.50	1.31	2.06	18.50	17.90	21.00	Ø0.88	12	17



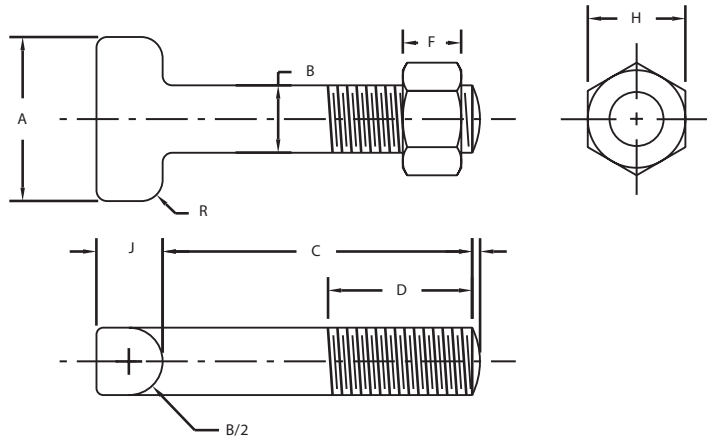

★ **TORNILLOS "T" (ACERO DE BAJA ALEACION)**

DIA. NOM.	A	B	C	D	ROSCA POR PULGADA	F	H	J	R
5/8 x 3	1.50	0.625	3.00	2.00	11	0.625	1.062	0.625	0.312
5/8 x 3 1/2	1.50	0.625	3.50	2.70	11	0.625	1.062	0.625	0.312
3/4 x 3 1/2	1.75	0.750	3.50	2.50	10	0.750	1.250	0.750	0.375
3/4 x 4	1.75	0.750	4.00	3.00	10	0.750	1.250	0.750	0.375
3/4 x 4 1/2	1.75	0.750	4.50	3.00	10	0.750	1.250	0.750	0.375
3/4 x 5	1.75	0.750	5.00	3.00	10	0.750	1.250	0.750	0.375
3/4 x 5 1/2	1.75	0.750	5.50	3.70	10	0.750	1.250	0.750	0.375
1 x 6	2.25	1.000	6.00	3.00	8	1.000	1.625	1.000	0.500
1 1/4 x 6 1/2	2.50	1.250	6.50	3.50	7	1.250	2.000	1.250	0.625

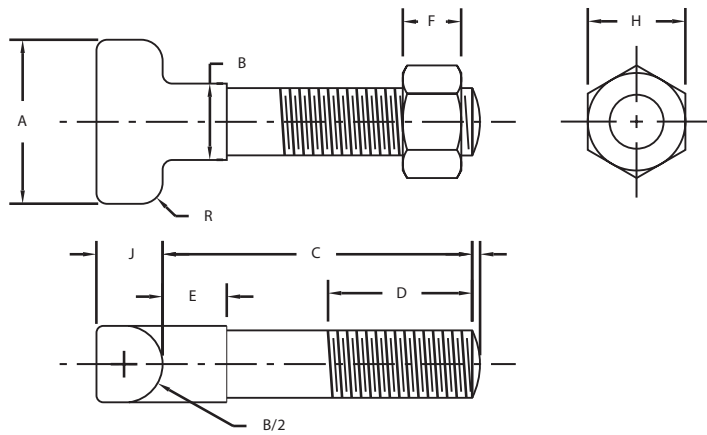

★ **TORNILLOS "T" (ACERO DE BAJA ALEACION) ANTI-ROTACION**

DIA. NOM.	A	B	C	D	E	ROSCA POR PULGADA	F	H	J	R
5/8 x 3	1.50	0.625	3.00	2.00	0.63	11	0.625	1.062	0.625	0.312
3/4 x 3 1/2	1.75	0.750	3.50	2.50	0.63	10	0.750	1.250	0.750	0.375
3/4 x 4	1.75	0.750	4.00	3.00	0.63	10	0.750	1.250	0.750	0.375
3/4 x 4 1/2	1.75	0.750	4.50	3.00	0.63	10	0.750	1.250	0.750	0.375
3/4 x 5	1.75	0.750	5.00	3.00	0.63	10	0.750	1.250	0.750	0.375

★ No Incluido en AWWA C153

REV.10.01

STAR PIPE PRODUCTS - División América Latina



4018 Westhollow Parkway | Houston, Texas 77079
+1 281 558 3000 (tel) +1 281 558 9000 (fax)
www.starpipeproducts.com



CONEXIONES JUNTA MECANICA
ANSI/AWWA C153/A21.53

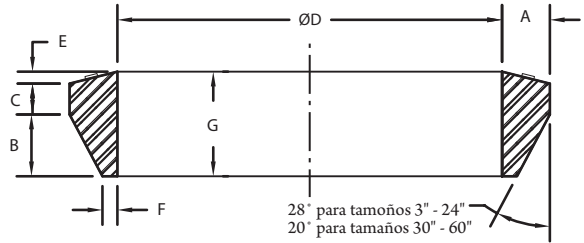
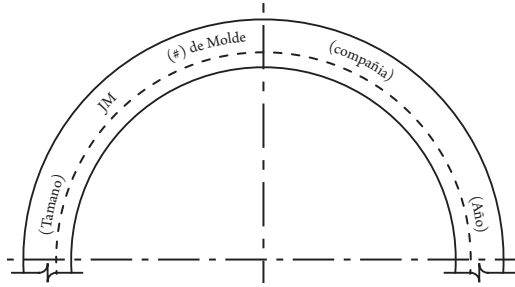

EMPAQUES PARA JUNTA MECANICA								
DIA. NOM.	PIPE O.D.	A	B	C	ØD ±1 %	E	F	G
2	2.50	0.48	0.62	0.31	2.48	0.12	0.15	1.05
3	3.96	0.48	0.62	0.31	3.86	0.12	0.15	1.05
4	4.80	0.62	0.75	0.31	4.68	0.16	0.22	1.22
6	6.90	0.62	0.75	0.31	6.73	0.16	0.22	1.22
8	9.05	0.62	0.75	0.31	8.85	0.16	0.22	1.22
10	11.10	0.62	0.75	0.31	10.87	0.16	0.22	1.22
12	13.20	0.62	0.75	0.31	12.95	0.16	0.22	1.22
14	15.30	0.62	0.75	0.31	14.99	0.16	0.22	1.22
16	17.40	0.62	0.75	0.31	17.07	0.16	0.22	1.22
18	19.50	0.62	0.75	0.31	19.13	0.16	0.22	1.22
20	21.60	0.62	0.75	0.31	21.20	0.16	0.22	1.22
24	25.80	0.62	0.75	0.31	25.34	0.16	0.22	1.22
30	32.00	0.73	1.00	0.38	31.47	0.16	0.37	1.54
36	38.30	0.73	1.00	0.38	37.67	0.16	0.37	1.54
42	44.50	0.73	1.00	0.38	43.78	0.16	0.37	1.54
48	50.80	0.73	1.00	0.38	49.98	0.16	0.37	1.54
54	{ Dimensiones disponibles bajo soliatud }							
60								
64								

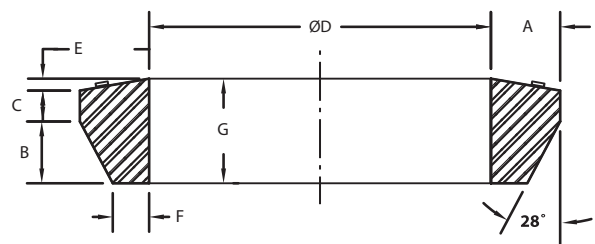
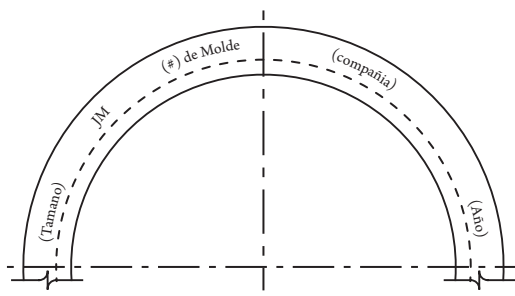

★ EMPAQUES DE TRANSICION PARA JUNTA MECANICA								
DIA. NOM.	PIPE O.D.	A	B	C (REF.)	ØD ±1 %	E	F	G
2	2.375	0.56	0.66	0.31	2.32	0.12	0.21	1.10
3	3.500	0.72	0.64	0.34	3.43	0.12	0.38	1.10
4	4.500	0.76	0.73	0.33	4.43	0.20	0.37	1.26
6	6.625	0.75	0.73	0.32	6.53	0.20	0.36	1.25
8	8.625	0.82	0.73	0.34	8.50	0.20	0.43	1.27
10	10.750	0.79	0.75	0.31	10.59	0.20	0.39	1.26
12	12.750	0.84	0.75	0.33	12.56	0.20	0.44	1.28



**4" - 24" CONEXIONES COMPACT DE EMPUJE****ESPECIFICACIONES GENERALES**

- MATERIAL:** Hierro dúctil según ASTM A536
- PRESIÓN:** 350 PSI para 4" - 24", presión aplicable solamente a las piezas y no incluye los seguros de restricción
- PRUEBAS:** Conforme con la norma ANSI / AWWA C153/A21.53 y los requisitos de UL
- LONGITUD:** Conforme con la norma ANSI / AWWA C153/A21.53 (Piezas que no están incluidas en las normas ANSI / AWWA están identificadas con un asterisco y son diseñadas por Star Pipe Products)
- PESO:** En libras, a menos que se indique lo contrario y no incluyen los accesorios, revestimiento de cemento, y recubrimientos
- BRIDAS:** Conforme con la norma ANSI / AWWA C115/A21.15 y ANSI B16.1 clase 125 bridas
- FORRO DE CEMENTO:** Conforme con la norma ANSI / AWWA C104/A21.4, tamaños de 4" - 24" son de doble grosor
- RECUBRIMIENTO:** Pintura con Bituminosa por dentro y fuera, conforme con la norma ANSI / AWWA C104/A21.4
- EMPAQUES:** SBR doble de dureza, conforme con la norma ANSI / AWWA C111/A21.11 (ver página. 34)
- APROBACIONES:** 4" - 12" Listado en Underwriters Laboratories (UL) y 4" y mayores certificado a la norma UL/NSF-61
- DIMENSIONES:** Todas las dimensiones son en pulgadas a menos que se indique lo contrario

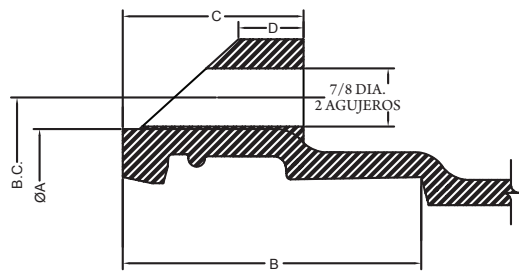

4"-12" TAMAÑO

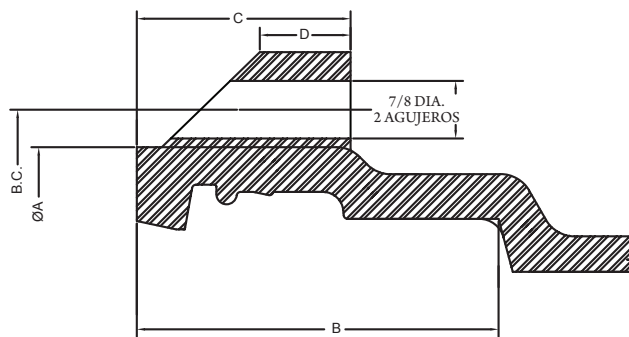

14"-24" TAMAÑO

**DIMENSIONES DE JUNTA DE EMPUJE**

DIA. NOM.	ØA	B.C.	B	C	D
4	6.38	7.50	4.02	2.17	1.12
6	8.52	9.56	4.02	2.17	1.12
8	10.80	11.82	4.49	2.72	1.12
10	12.91	14.00	4.49	2.91	1.12
12	15.05	16.25	5.00	2.99	1.12
14	17.65	18.75	5.50	3.12	1.25
16	19.81	21.00	5.50	3.25	1.25
18	22.11	23.25	5.50	3.25	1.25
20	24.23	25.50	5.50	3.25	1.25
24	28.55	30.00	6.00	3.25	1.25

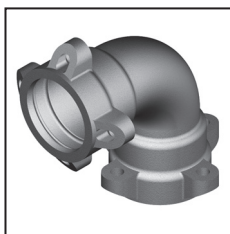

NOTA: Todas las piezas son vienen, con dos (2) seguros de restricción. Sin embargo los codos de 45° y 90° en tamaños de 4" - 12" también están disponibles con cuatro (4) seguros de restricción.





CONEXIONES DE EMPUJE

ANSI/AWWA C153/A21.53

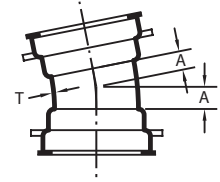
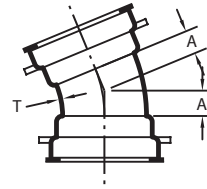
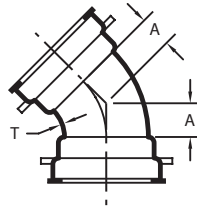
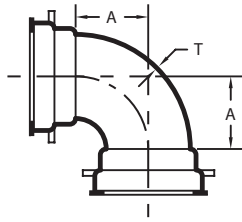

CODOS: PO x PO		CODOS 90° (1/4) PO x PO		CODOS 45° (1/8) PO x PO		CODOS 22 1/2° (1/16) PO x PO		CODOS 11 1/4° (1/32) PO x PO	
DIA. NOM.	T	A	PESO (LBS.)	A	PESO (LBS.)	A	T (LBS.)	A	PESO (LBS.)
4	0.34	4.00	26	2.00	23	1.50	22	1.25	21
6	0.36	5.00	41	3.00	38	2.00	34	1.50	32
8	0.38	6.50	71	3.50	54	2.50	55	1.75	52
10	0.40	7.50	98	4.50	87	3.00	75	2.00	67
12	0.42	8.75	139	5.50	110	3.50	105	2.25	95
14	0.47	11.50	254	5.00	143	3.75	162	2.50	113
16	0.50	12.50	275	5.50	206	3.75	168	2.50	172
18	0.54	14.00	391	6.00	309	4.50	209	3.00	209
20	0.57	15.00	476	7.00	351	4.50	400	3.00	265
24	0.61	17.00	704	7.50	414	7.50	410	3.00	315

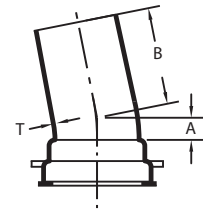
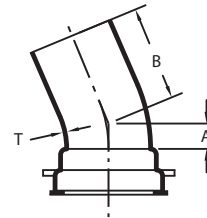
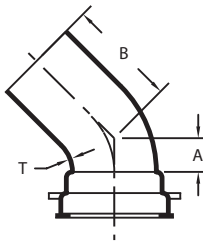
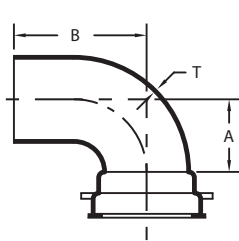

CODOS: PO x ESPIGA		CODOS 90° (1/4) PO x ESPIGA			CODOS 45° (1/8) PO x ESPIGA			CODOS 22 1/2° (1/16) PO x ESPIGA			CODOS 11 1/4° (1/32) PO x ESPIGA		
DIA. NOM.	T	A	B	PESO (LBS.)	A	B	PESO (LBS.)	A	B	PESO (LBS.)	A	B	PESO (LBS.)
4	0.34	4.00	10.50	24	2.00	8.00	21	1.50	8.00	19	1.25	7.00	18
6	0.36	5.00	12.00	47	3.00	9.00	38	2.00	8.00	35	1.50	7.25	34
8	0.38	6.50	13.00	75	3.50	9.50	60	2.50	8.50	57	1.75	7.50	55

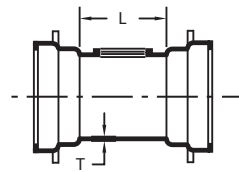
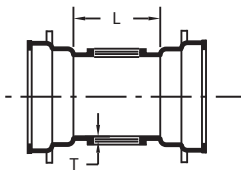

CRUCES: PO x ROSCA				
DIA. NOM.	T	T1	ROSCA MAX.	PESO (LBS.)
4	0.34	6.00	3	35
6	0.36	6.00	3	45
8	0.38	6.00	3	61
10	0.40	6.00	3	100
12	0.42	6.00	3	140

TEES: PO x ROSCA				
DIA. NOM.	T	T1	ROSCA MAX.	PESO (LBS.)
4	0.34	6.00	3	35
6	0.36	6.00	3	45
8	0.38	6.00	3	61
10	0.40	6.00	3	100
12	0.42	6.00	3	140

Rosca conforme a ANSI/ASME B1.20.1

Rosca conforme a ANSI/ASME B1.20.1





CONEXIONES DE EMPUJE

ANSI/AWWA C153/A21.53

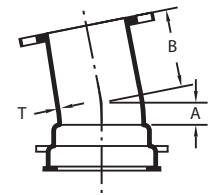
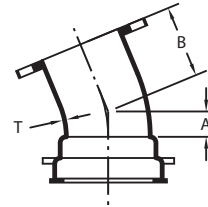
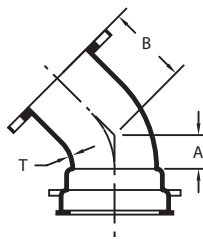
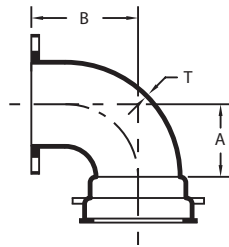

★ CODOS: PO x BRIDA		CODOS 90° (¼) PO x BRIDA			CODOS 45° (⅛) PO x BRIDA			CODOS 22 ½° (⅙) PO x BRIDA			CODOS 11 ¼° (⅓₂) PO x BRIDA		
DIA. NOM.	T	A	B	PESO (LBS.)	A	B	PESO (LBS.)	A	B	PESO (LBS.)	A	B	PESO (LBS.)
4	0.34	4.50	6.50	33	2.00	4.00	21	1.50	4.00	25	1.25	4.00	24
6	0.36	5.50	8.00	47	3.00	5.00	42	2.00	5.00	44	1.50	5.00	30
8	0.38	6.50	9.00	76	3.50	5.50	60	2.50	5.50	64	1.75	5.50	61
10	0.40	7.50	11.00	130	4.50	6.50	93	3.00	6.50	90	2.00	6.50	80
12	0.42	8.75	12.00	158	5.50	7.50	122	3.50	7.50	112	2.25	7.50	94
14	0.47	11.50	14.00	231	5.00	7.50	162	3.75	7.50	174	2.50	7.50	170
16	0.50	12.50	15.00	350	5.50	8.00	275	3.75	8.00	228	2.50	8.00	228
24	0.61	17.00	22.00	---	---	---	---	---	---	---	---	---	---

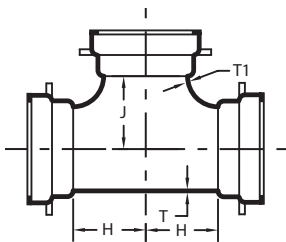

TEES: PO x PO					
DIA. NOM.	T	T1	H	J	PESO (LBS.)
4 x 4	0.34	0.34	4.00	4.00	40
6 x 4	0.36	0.34	4.00	5.00	50
6 x 6	0.36	0.36	5.00	5.00	59
8 x 4	0.38	0.34	4.00	6.50	75
8 x 6	0.38	0.36	5.00	6.50	88
8 x 8	0.38	0.38	6.50	6.50	99
10 x 4	0.40	0.34	4.00	7.50	95
10 x 6	0.40	0.36	5.00	7.50	103
10 x 8	0.40	0.38	6.50	7.50	122
10 x 10	0.40	0.40	7.50	7.50	134
12 x 4	0.42	0.34	4.00	8.75	122
12 x 6	0.42	0.36	5.00	8.75	126
12 x 8	0.42	0.38	6.50	8.75	148
12 x 10	0.42	0.40	7.50	8.75	161
12 x 12	0.42	0.42	8.75	8.75	192
14 x 6	0.47	0.36	6.50	10.50	176
14 x 10	0.47	0.40	8.50	10.50	195
14 x 12	0.47	0.42	9.50	10.50	196
14 x 14	0.47	0.47	10.50	10.50	209

TEES: PO x PO (CONT.)					
DIA. NOM.	T	T1	H	J	PESO (LBS.)
16 x 6	0.50	0.36	6.50	11.50	221
16 x 8	0.50	0.38	7.50	11.50	257
16 x 10	0.50	0.40	8.50	11.50	232
16 x 12	0.50	0.42	9.50	11.50	288
16 x 14	0.50	0.47	10.50	11.50	349
16 x 16	0.50	0.50	12.50	12.50	261
18 x 6	0.54	0.36	6.50	12.50	320
18 x 8	0.54	0.38	7.50	12.50	325
18 x 10	0.54	0.40	8.50	12.50	344
18 x 12	0.54	0.42	9.50	12.50	385
18 x 14	0.54	0.47	10.50	12.50	352
18 x 16	0.54	0.50	11.50	12.50	362
18 x 18	0.54	0.54	14.00	14.00	550
20 x 6	0.57	0.36	6.50	14.00	355
20 x 10	0.57	0.40	9.00	14.00	369
20 x 12	0.57	0.42	10.00	14.00	457
20 x 14	0.57	0.47	11.00	14.00	484
20 x 16	0.57	0.50	12.00	14.00	610
20 x 18	0.57	0.54	13.00	14.00	639
20 x 20	0.57	0.57	15.00	15.00	644
24 x 6	0.61	0.36	7.00	16.00	450
24 x 8	0.61	0.38	8.00	16.00	492
24 x 10	0.61	0.40	9.00	16.00	520
24 x 12	0.61	0.42	10.00	16.00	541
24 x 14	0.61	0.47	11.00	16.00	715
24 x 16	0.61	0.50	12.00	16.00	755
24 x 18	0.61	0.54	13.00	16.00	708
24 x 20	0.61	0.57	14.00	16.00	845
24 x 24	0.61	0.61	17.00	17.00	884

(Cont.)➔





CONEXIONES DE EMPUJE

ANSI/AWWA C153/A21.53

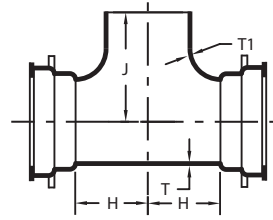
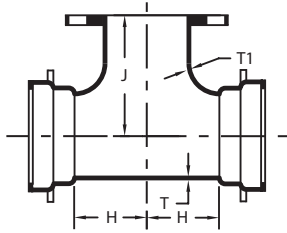

TEES: PO x BRIDA					
DIA. NOM.	T	T1	H	J	PESO (LBS.)
4 x 4	0.34	0.34	4.50	6.50	47
6 x 4	0.36	0.34	4.50	8.00	60
6 x 6	0.36	0.36	5.50	8.00	69
8 x 4	0.38	0.34	4.50	9.00	81
8 x 6	0.38	0.36	5.50	9.00	87
8 x 8	0.38	0.38	6.50	9.00	115
10 x 4	0.40	0.34	4.50	11.00	97
10 x 6	0.40	0.36	5.50	11.00	114
10 x 8	0.40	0.38	6.50	11.00	133
10 x 10	0.40	0.40	7.50	11.00	165
12 x 4	0.42	0.34	4.50	12.00	125
12 x 6	0.42	0.36	5.50	12.00	131
12 x 8	0.42	0.38	6.50	12.00	166
12 x 10	0.42	0.40	7.50	12.00	142
12 x 12	0.42	0.42	8.75	12.00	210
16 x 6	0.50	0.36	6.50	15.00	236
16 x 8	0.50	0.38	7.50	15.00	269
16 x 10	0.50	0.40	8.50	15.00	310
16 x 12	0.50	0.42	9.50	15.00	348
16 x 14	0.50	0.47	10.50	15.00	342
16 x 16	0.50	0.50	11.50	15.00	355
18 x 6	0.54	0.36	6.50	15.50	301
18 x 8	0.54	0.38	7.50	15.50	319
18 x 10	0.54	0.40	8.50	15.50	337
18 x 14	0.54	0.47	10.50	15.50	393
18 x 16	0.54	0.50	11.50	15.50	420
20 x 6	0.57	0.36	6.50	17.00	341
20 x 10	0.57	0.40	9.00	17.00	420
20 x 14	0.57	0.47	11.00	17.00	474
20 x 16	0.57	0.50	12.00	18.00	498
20 x 18	0.57	0.54	13.00	18.00	528
24 x 6	0.61	0.36	7.00	19.00	420
24 x 10	0.61	0.40	9.00	19.00	468
24 x 12	0.61	0.42	10.00	19.00	503
24 x 14	0.61	0.47	11.00	19.00	531
24 x 16	0.61	0.50	12.00	19.00	555

TEES: PO x ESPIGA					
DIA. NOM.	T	T1	H	J	PESO (LBS.)
6 x 6	0.36	0.36	5.00	11.50	55
8 x 6	0.38	0.36	5.00	12.50	75
12 x 6	0.42	0.36	5.00	15.50	130

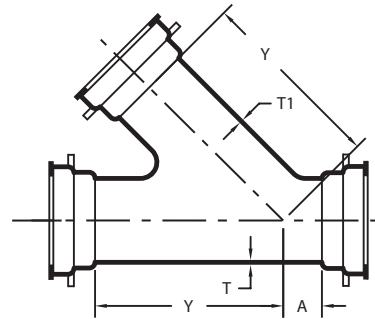

"Y" LATERALES 45° PO					
DIA. NOM.	T	T1	A	Y	PESO (LBS.)
6 x 4	0.36	0.34	3.00	13.00	76
6 x 6	0.36	0.36	3.00	13.00	85
8 x 4	0.38	0.34	3.50	16.00	89
8 x 6	0.38	0.36	3.50	16.00	125
8 x 8	0.38	0.38	3.50	16.00	140
10 x 4	0.40	0.34	3.50	19.00	144
10 x 6	0.40	0.36	3.50	19.00	154
10 x 8	0.40	0.38	3.50	19.00	160
10 x 10	0.40	0.40	3.50	19.00	170
12 x 4	0.42	0.34	4.50	22.50	224
12 x 6	0.42	0.36	4.50	22.50	236
12 x 8	0.42	0.38	4.50	22.50	259
12 x 10	0.42	0.40	4.50	22.50	282
12 x 12	0.42	0.42	4.50	22.50	300
14 x 6	0.47	0.36	0.00	19.50	236
14 x 8	0.47	0.38	1.50	21.00	255
14 x 10	0.47	0.40	3.00	22.50	325
14 x 14	0.47	0.47	6.00	25.00	475
16 x 6	0.50	0.36	0.00	21.00	281
16 x 8	0.50	0.38	1.00	22.50	305
16 x 12	0.50	0.42	3.50	25.00	346
16 x 16	0.50	0.50	6.00	28.00	380





CONEXIONES DE EMPUJE

ANSI/AWWA C153/A21.53

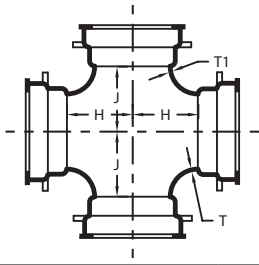

CRUCES: PO					
DIA. NOM.	T	T1	H	J	PESO (LBS.)
4 x 4	0.34	0.34	4.00	4.00	55
6 x 6	0.36	0.36	5.00	5.00	74
8 x 6	0.38	0.36	5.00	6.50	103
8 x 8	0.38	0.38	6.50	6.50	115
10 x 4	0.40	0.34	4.00	7.50	116
10 x 8	0.40	0.38	6.50	7.50	150
10 x 10	0.40	0.40	7.50	7.50	160
12 x 8	0.42	0.38	6.50	8.75	171
12 x 10	0.42	0.40	7.50	8.75	176
12 x 12	0.42	0.42	8.75	8.75	216
14 x 6	0.47	0.36	6.50	10.50	189
14 x 8	0.47	0.38	7.50	10.50	204
14 x 10	0.47	0.40	8.50	10.50	222
14 x 12	0.47	0.42	9.50	10.50	239
14 x 14	0.47	0.47	10.50	10.50	270
16 x 6	0.50	0.36	6.50	11.50	234
16 x 8	0.50	0.38	7.50	11.50	245
16 x 10	0.50	0.40	8.50	11.50	268
16 x 12	0.50	0.42	9.50	11.50	274
16 x 14	0.50	0.47	10.50	11.50	322
16 x 16	0.50	0.50	12.50	12.50	417
24 x 24	0.61	0.61	17.00	17.00	1056

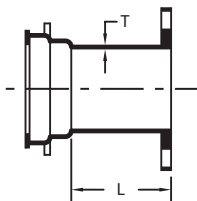

ADAPTADORES: PO x BRIDA			
DIA. NOM.	T	L	PESO (LBS.)
4	0.34	3.50	22
6	0.36	3.50	34
8	0.38	3.50	46
10	0.40	3.50	59
12	0.42	3.50	98
14	0.47	5.00	113
16	0.50	5.00	180
20	0.57	5.00	244
24	0.61	5.00	308

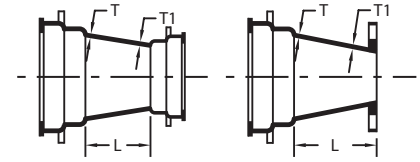

DIA. NOM.	T	T1	PO x PO		PO x BRIDA	
			L	PESO (LBS.)	L	PESO (LBS.)
6 x 4	0.36	0.34	4.00	30	6.00	32
8 x 4	0.38	0.34	5.00	42	7.00	46
8 x 6	0.38	0.36	4.00	43	6.00	47
10 x 4	0.40	0.34	7.00	53	9.00	55
10 x 6	0.40	0.36	5.00	58	7.00	59
10 x 8	0.40	0.38	4.00	62	6.00	61
12 x 4	0.42	0.34	9.00	70	11.00	78
12 x 6	0.42	0.36	7.00	77	9.00	73
12 x 8	0.42	0.38	5.00	80	7.00	74
12 x 10	0.42	0.40	4.00	82	6.00	95
14 x 6	0.47	0.36	9.00	84	11.00	121
14 x 8	0.47	0.38	7.00	85	9.00	128
14 x 10	0.47	0.40	5.00	87	7.00	127
14 x 12	0.47	0.42	4.00	104	6.00	144
16 x 6	0.50	0.36	11.00	138	13.00	133
16 x 8	0.50	0.38	9.00	137	11.00	141
16 x 10	0.50	0.40	7.00	130	9.00	158
16 x 12	0.50	0.42	5.00	135	7.00	172
16 x 14	0.50	0.47	4.00	139	6.00	196
18 x 8	0.54	0.38	13.00	140	16.00	157
18 x 10	0.54	0.40	10.00	142	14.00	175
18 x 12	0.54	0.42	7.00	167	12.00	215
18 x 14	0.54	0.47	6.00	217	11.50	234
18 x 16	0.54	0.50	5.00	202	10.50	246
20 x 10	0.57	0.40	14.00	180	16.00	234
20 x 12	0.57	0.42	12.00	205	---	---
20 x 14	0.57	0.47	10.00	233	13.50	249
20 x 16	0.57	0.50	7.00	250	11.50	272
20 x 18	0.57	0.54	4.00	248	---	---
24 x 12	0.61	0.42	16.00	308	18.00	262
24 x 14	0.61	0.47	14.00	340	17.50	315
24 x 16	0.61	0.50	12.00	324	15.50	328
24 x 18	0.61	0.54	10.00	390	---	---
24 x 20	0.61	0.57	7.00	421	---	---

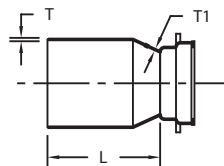

ESPIGA x CAMPANA DE PO				
DIA. NOM.	T	T1	L	PESO (LBS.)
6 x 4	0.38	0.34	9.50	45
8 x 6	0.38	0.36	9.50	44
12 x 6	0.42	0.36	12.50	58
12 x 8	0.42	0.38	10.50	81





CONEXIONES DE EMPUJE

ANSI/AWWA C153/A21.53

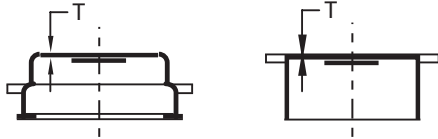

TAPAS PO HEMBRA Y MACHO (CIEGA O ROSCA)				
DIA. NOM.	T	ROSCA MAX.	PESO (LBS.)	
			TAPAS HEMBRA	TAPAS MACHO
4	0.37	2	13	12
6	0.39	2	20	17
8	0.41	2	30	29
10	0.44	2	40	36
12	0.46	2	62	47
14	0.60	2	70	74
16	0.76	2	101	86
20	0.83	2	156	144
24	0.90	2	212	202

Rosca conforme a ANSI/ASME B1.20.1

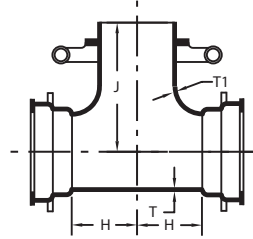

TEE HIDRANTE: PO x ESLABON GIRATORIO (SWIVEL)					
DIA. NOM.	T	T1	H	J	PESO (LBS.)
6 x 6	0.36	0.36	6.00	9.50	71
8 x 6	0.38	0.36	6.00	10.50	87
10 x 6	0.40	0.36	7.00	12.50	100
12 x 6	0.42	0.36	7.00	13.50	138
16 x 6	0.50	0.36	6.50	15.00	229
20 x 6	0.57	0.36	7.00	17.50	400
24 x 6	0.61	0.36	7.00	19.50	525

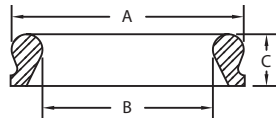

EMPAQUES PARA PO				
DIA. NOM.	A	B	C	PESO (LBS.)
4	5.74	4.54	1.00	0.40
6	7.86	6.64	1.00	0.60
8	10.15	8.73	1.21	0.70
10	12.22	10.80	1.30	0.90
12	14.34	12.92	1.30	1.00
14	16.90	15.90	1.65	1.30
16	19.01	17.01	1.65	1.45
18	21.13	19.13	1.65	1.60
20	23.25	21.25	1.65	1.75
24	27.48	25.48	1.65	1.95

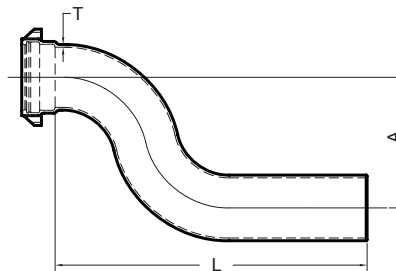

DESVIACIONES: PO X ESPIGA				
DIA. NOM.	T	A	L	PESO (LBS.)
4	0.34	18	30	80
6	0.36	18	41	107
8	0.38	18	43	166
12	0.42	18	56	297



1" - 64" CONEXIONES DE BRIDA DE HIERRO DÚCTIL

ESPECIFICACIONES GENERALES

- MATERIAL:** Hierro dúctil según ASTM A536
- PRESIÓN:** 250 PSI para 1" - 48", 150 PSI para 54" - 64"
- PRUEBAS:** Conforme con la norma ANSI / AWWA C110/A21.10 y los requisitos de UL y FM
- LONGITUD:** Tamaños de 2" - 48" conforme a norma ANSI / AWWA C110/A21.10 y ANSI B16.1 y tamaños de 54" - 64" conforme a la norma ANSI / AWWA C153/A21.53
- PESO:** En libras, a menos que se indique lo contrario y no incluyen los accesorios, revestimiento de cemento, y recubrimientos
- AGUJEROS:** Conforme con la norma ANSI / AWWA C110/A21.10, ANSI/AWWA C153/A21.53 y ANSI B16.1 Clase 125 bridas
- FORRO DE CEMENTO:** Conforme con la norma ANSI / AWWA C104/A21.4, tamaños de 1" - 3" de espesor solo y tamaños 4" - 64" son de doble grosor
- RECUBRIMIENTO:** Pintura Bituminosa interna, conforme a la norma ANSI / AWWA C104/A21.4 y el exterior tiene un recubrimiento resistente a la corrosión de color rojo
- APROBACIONES:** 4" - 12" Listado en Underwriters Laboratories (UL) y aprobado por Factory Mutual (FM) para 300 PSI 2" y mayores certificado a la norma UL/NSF-61
- DIMENSIONES:** Todas las dimensiones son en pulgadas a menos que se indique lo contrario

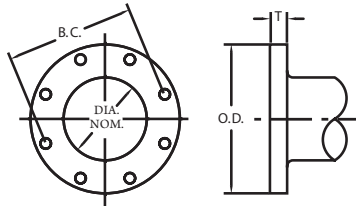

DIMENSIONES DE BRIDA							
DIA. NOM.	O.D.	B.C.	T	DIA. AGUJERO	TORNILLOS		
					TAMAÑOS	NO.	
★ 1	4.25	3.12	0.44	0.62	1/2 x 2	4	
★ 1 1/2	5.00	3.88	0.56	0.62	1/2 x 2	4	
★ 2	6.00	4.75	0.62	0.75	5/8 x 2 1/4	4	
★ 2 1/2	7.00	5.50	0.69	0.75	5/8 x 2 1/2	4	
3	7.50	6.00	0.75	0.75	5/8 x 2 1/2	4	
4	9.00	7.50	0.94	0.75	5/8 x 3	8	
★ 5	10.00	8.50	0.94	0.88	3/4 x 3	8	
6	11.00	9.50	1.00	0.88	3/4 x 3 1/2	8	
8	13.50	11.75	1.12	0.88	3/4 x 3 1/2	8	
10	16.00	14.25	1.19	1.00	7/8 x 4	12	
12	19.00	17.00	1.25	1.00	7/8 x 4	12	
14	21.00	18.75	1.38	1.13	1 x 4 1/2	12	
16	23.50	21.25	1.44	1.13	1 x 4 1/2	16	
18	25.00	22.75	1.56	1.25	1 5/8 x 5	16	
20	27.50	25.00	1.69	1.25	1 5/8 x 5	20	
24	32.00	29.50	1.88	1.38	1 1/4 x 5 1/2	20	
30	38.75	36.00	2.12	1.38	1 1/4 x 6 1/2	28	
36	46.00	42.75	2.38	1.63	1 1/2 x 7	32	
42	53.00	49.50	2.62	1.63	1 1/2 x 7 1/2	36	
48	59.50	56.00	2.75	1.63	1 1/2 x 8	44	
★ 54	66.25	62.75	3.00	2.00	1 3/4 x 8 1/2	44	
★ 60	73.00	69.25	3.12	2.00	1 3/4 x 9	52	
★ 64	80.00	76.00	3.38	2.00	1 3/4 x 9	52	

★No Incluido en AWWA C110

REV.10.01

STAR PIPE PRODUCTS - División América Latina

4018 Westhollow Parkway | Houston, Texas 77079
 +1 281 558 3000 (tel) +1 281 558 9000 (fax)
 www.starpipeproducts.com



DISEÑO DE BRIDAS ESPECIALES DE REDUCCIÓN

Tees de reducción

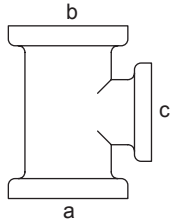

Reducir en "c"

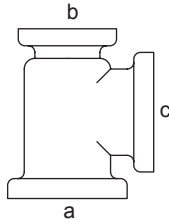

Reducir en "b"

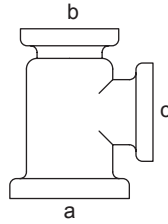

Reducir en "b" y "c"

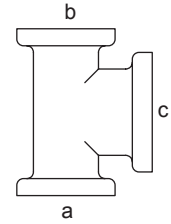

Reducir en "a" y "b"

Cruces de reducción

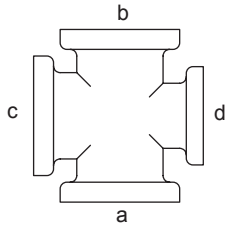

Reducir en "c" o "d"

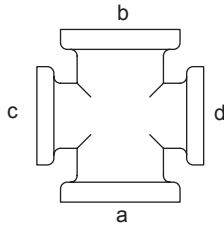

Reducir en "c" y "d"

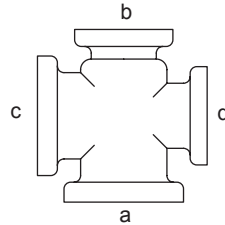

Reducir en "b" y "d"

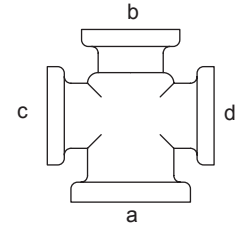

Reducir en "b," "c" y "d"

Laterales de Reducción

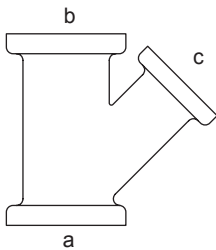

Reducir en "c"

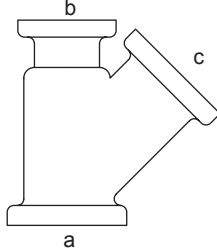

Reducir en "b"

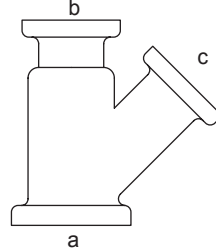

Reducir en "b" y "c"

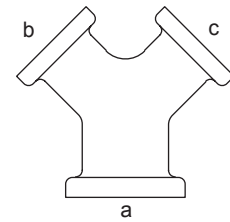

Reducir en "b" y "c"

Tee con Salida Lateral

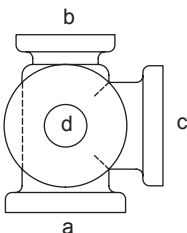

Mano Derecha

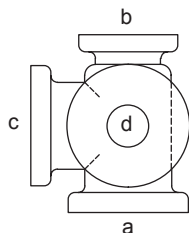

Mano Izquierda

Doble Codo

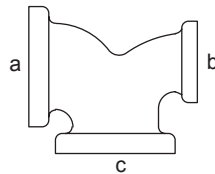

Codo de 90° con Salida Lateral

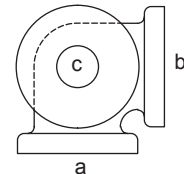

Mano Derecha

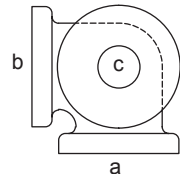

Mano Izquierda

En el diseño de las reducciones, se debe seguir la secuencia de las letras a, b, c, d.



LOCALIZACIÓN DE AGUJEROS ROSCADOS DE DRENAJE

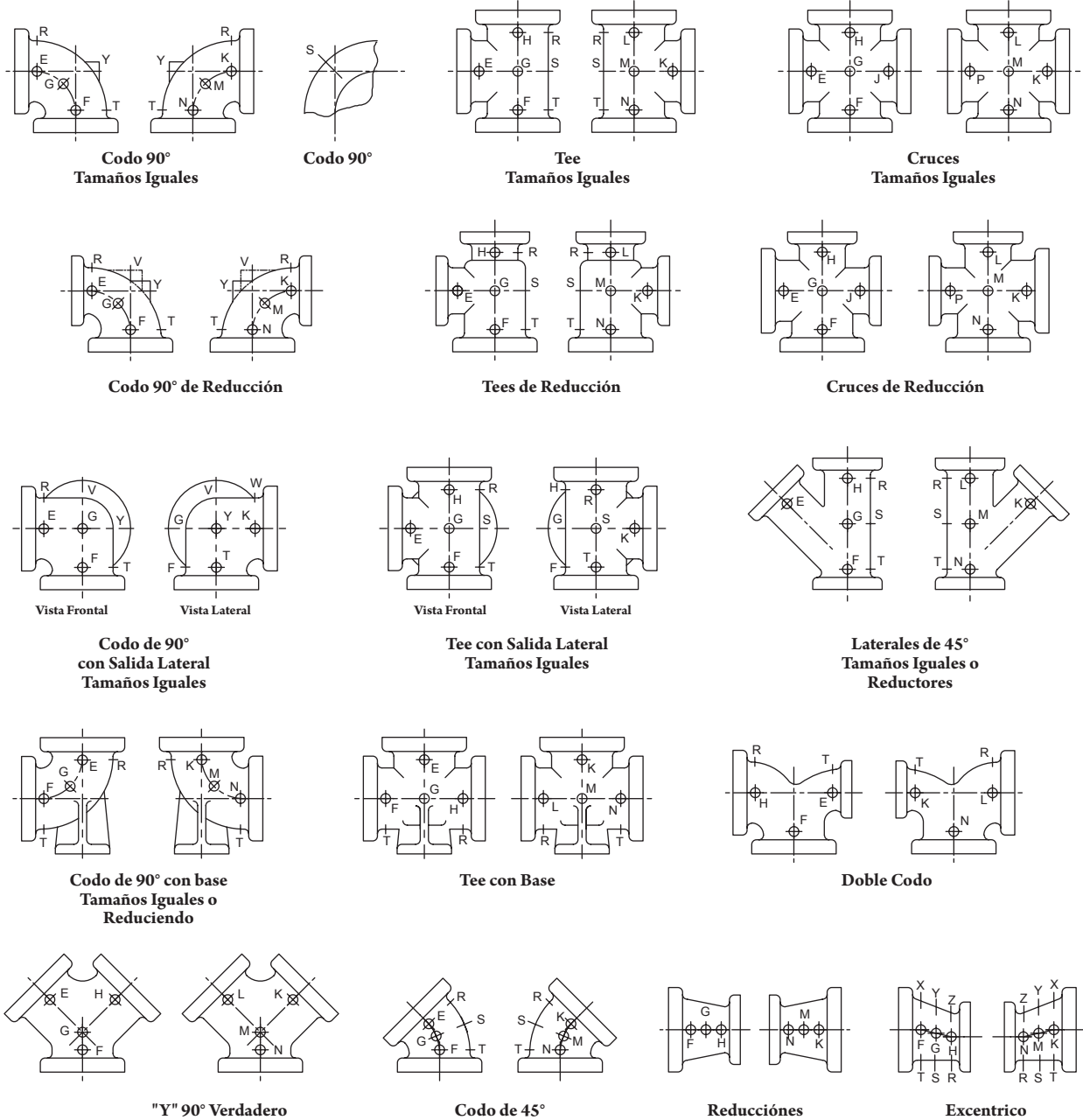

DIA. NOM.	ROSCA MAX SIN BOSS
3	½
4-6	¾
8	1 ¼
10-16	1 ½
18-64	2

★No Incluido en AWWA C110

STAR PIPE PRODUCTS - División América Latina

4018 Westhollow Parkway | Houston, Texas 77079
 +1 281 558 3000 (tel) +1 281 558 9000 (fax)
 www.starpipeproducts.com



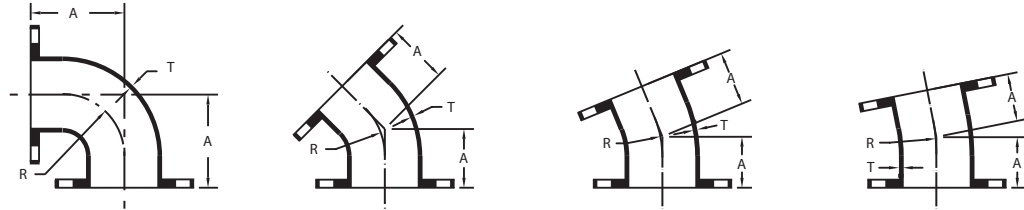

CODOS		CODOS 90° (1/4)			CODOS 45° (1/8)			CODOS 22 1/2° (1/16)			CODOS 11 1/4° (1/32)		
DIA. NOM.	T	A	R	PESO (LBS.)	A	R	PESO (LBS.)	A	R	PESO (LBS.)	A	R	PESO (LBS.)
★ 2	0.31	4.50	3.00	14	2.50	2.41	12	2.50	6.04	12	2.50	12.69	12
★ 2 1/2	0.31	5.00	3.50	21	3.00	3.62	19	---	---	---	---	---	---
3	0.48	5.50	4.00	25	3.00	3.62	20	3.00	7.56	20	3.00	15.25	20
4	0.52	6.50	4.50	45	4.00	4.81	40	4.00	10.06	40	4.00	20.31	40
★ 5	0.88	7.50	5.50	52	4.50	6.04	45	---	---	---	---	---	---
6	0.55	8.00	6.00	65	5.00	7.25	55	5.00	15.06	55	5.00	30.50	55
8	0.60	9.00	7.00	105	5.50	8.44	90	5.50	17.62	90	5.50	35.50	90
10	0.68	11.00	9.00	165	6.50	10.88	130	6.50	22.62	135	6.50	45.69	135
12	0.75	12.00	10.00	235	7.50	13.25	195	7.50	27.62	205	7.50	55.81	205
14	0.66	14.00	11.50	290	7.50	12.06	220	7.50	25.12	225	7.50	50.75	225
16	0.70	15.00	12.50	370	8.00	13.25	280	8.00	27.62	285	8.00	55.81	285
18	0.75	16.50	14.00	450	8.50	14.50	325	8.50	30.19	335	8.50	60.94	335
20	0.80	18.00	15.50	580	9.50	16.88	430	9.50	35.19	435	9.50	71.06	435
24	0.89	22.00	18.50	900	11.00	18.12	630	11.00	37.69	640	11.00	76.12	645
30	1.03	25.00	21.50	1430	15.00	27.75	1120	15.00	57.81	1135	15.00	116.75	1150
36	1.15	28.00	24.50	2135	18.00	35.00	1755	18.00	72.88	1790	18.00	147.25	1805
42	1.28	31.00	27.50	3055	21.00	42.25	2600	21.00	88.00	2665	21.00	177.69	2680
48	1.42	34.00	30.50	4095	24.00	49.50	3580	24.00	103.06	3665	24.00	208.12	3695
★ 54	0.90	39.00	35.29	3740	20.50	41.05	2735	14.00	32.42	2260	12.00	30.81	2100
★ 60	0.94	43.00	---	4965	23.50	---	3790	14.00	---	2985	10.50	---	2665
★ 64	0.99	48.00	38.80	6745	25.00	---	5105	13.50	---	3995	9.50	---	3585

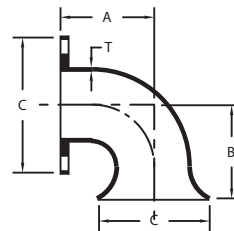
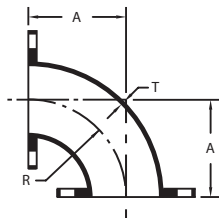

★ **CODOS 90° DE AMPLIO RADIO**

DIA. NOM.	T	B	C	PESO (LBS.)
3	0.48	7.75	6.25	30
4	0.52	9.00	7.00	50
6	0.55	11.50	9.50	80
8	0.60	14.00	12.00	140
10	0.68	16.50	14.50	215
12	0.75	19.00	17.00	325
14	0.66	21.50	19.00	400
16	0.70	24.00	21.50	525
18	0.75	26.50	24.00	750
20	0.80	29.00	26.50	875
24	0.89	34.00	30.50	1250
30	1.03	41.50	38.00	2105
36	1.15	49.00	45.50	3285
42	1.28	56.50	53.00	4865
48	1.42	64.00	60.50	7800
54	0.90	73.50	69.50	6205

★ **CODOS 90°: BRIDA x ABOCINADA**

DIA. NOM.	T	A	B	C	PESO (LBS.)
3	0.48	5.50	11.00	7.50	25
4	0.52	6.50	12.00	9.00	40
6	0.55	8.00	12.00	11.00	70
8	0.60	9.00	14.00	13.50	110
10	0.68	11.00	17.00	16.00	175
12	0.75	12.00	18.00	19.00	245
14	0.66	14.00	20.00	21.00	340
16	0.70	15.00	21.00	23.50	460
18	0.75	16.50	22.50	25.00	560
20	0.80	18.00	24.00	27.50	700
24	0.89	22.00	28.00	32.00	1100
30	1.03	25.00	32.00	38.75	1640
36	1.15	28.00	35.00	46.00	2700
42	1.28	31.00	38.00	53.00	3250
48	1.42	34.00	41.00	59.50	4215
54	0.90	39.00	46.00	66.25	3965

★No Incluido en AWWA C110

REV.10.01

STAR PIPE PRODUCTS - División América Latina

4018 Westhollow Parkway | Houston, Texas 77079
+1 281 558 3000 (tel) +1 281 558 9000 (fax)

www.starpipeproducts.com



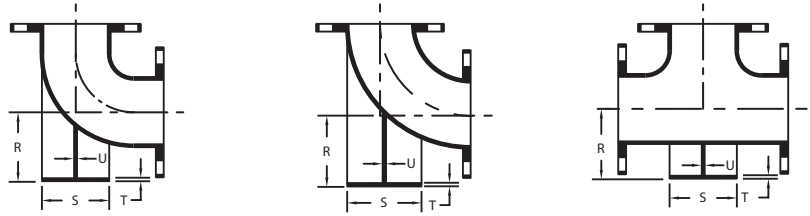

CONEXIONES BRIDADOS CON BASE

DIA. NOM.	R	S	T	U	PESO. (LBS.)		
					CODOS DE 90°	CODOS DE 90° RADIO LARGO	TEE
★ 2	4.12	4.62	0.50	0.50	17	---	23
★ 2 ½	4.50	4.62	0.50	0.50	25	---	34
3	4.88	5.00	0.56	0.50	35	40	45
4	5.50	6.00	0.62	0.50	55	60	75
★ 5	6.25	7.00	0.69	0.62	70	85	95
6	7.00	7.00	0.69	0.62	85	100	110
8	8.38	9.00	0.94	0.88	145	180	185
10	9.75	9.00	0.94	0.88	210	260	300
12	11.25	11.00	1.00	1.00	300	390	430
14	12.50	11.00	1.00	1.00	320	650	500
16	13.75	11.00	1.00	1.00	445	815	600
18	15.00	13.50	1.12	1.12	565	955	740
20	16.00	13.50	1.12	1.12	700	1200	930
24	18.50	13.50	1.12	1.12	1030	1770	1410
30	23.00	16.00	1.19	1.15	1625	2295	2270
36	26.00	19.00	1.25	1.15	2385	3535	3320
42	30.00	23.50	1.44	1.28	3465	5275	5850
48	34.00	25.00	1.56	1.42	4610	7305	7720
★ 54	38.00	27.50	1.69	1.55	4415	6880	6465

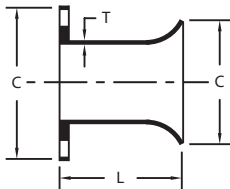

★ BRIDA x ABOCINADA

DIA. NOM.	T	L	C	PESO (LBS.)
3	0.48	8.00	7.50	20
4	0.52	8.00	9.00	30
6	0.55	8.00	11.00	40
8	0.60	10.00	13.50	70
10	0.68	10.00	16.00	95
12	0.75	12.00	19.00	155
14	0.66	12.00	21.00	190
16	0.70	16.00	23.50	330
18	0.75	16.00	25.00	355
20	0.80	18.00	27.50	460
24	0.89	18.00	32.00	635
30	1.03	24.00	38.75	1025
36	1.15	24.00	46.00	1460
42	1.28	30.00	53.00	1900
48	1.42	30.00	59.50	2350
54	0.90	36.00	66.25	2035

DIMENSIONES DE BASE

DIA. NOM.	B.C.	DIA. AGUJERO	NO. DE TORNILLOS
2	3.50	0.63	4
2 ½	3.50	0.63	4
3	3.88	0.63	4
4	4.75	0.75	4
5	5.50	0.75	4
6	5.50	0.75	4
8	7.50	0.75	4
10	7.50	0.75	4
12	9.50	0.88	4
14	9.50	0.88	4
16	9.50	0.88	4
18	11.75	0.88	4
20	11.75	0.88	4
24	11.75	0.88	4
30	14.25	1.00	4
36	17.00	1.00	4
42	21.25	1.13	4
48	22.75	1.25	4
54	25.00	1.25	4

★No Incluido en AWWA C110

STAR PIPE PRODUCTS - División América Latina

4018 Westhollow Parkway | Houston, Texas 77079
 +1 281 558 3000 (tel) +1 281 558 9000 (fax)
 www.starpipeproducts.com



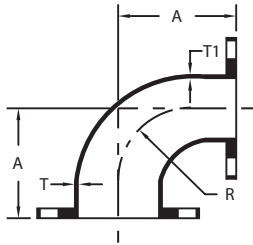

★ **CODOS 90° CON REDUCCIÓN**

DIA. NOM.	T	T1	A	R	PESO (LBS.)
3 x 1 1/2	0.48	0.31	5.50	4.00	18
3 x 2	0.48	0.31	5.50	4.00	20
3 x 2 1/2	0.48	0.31	5.50	4.00	23
4 x 2	0.52	0.31	6.50	4.50	29
4 x 2 1/2	0.52	0.31	6.50	4.50	33
4 x 3	0.52	0.48	6.50	4.50	35
5 x 2	0.50	0.31	7.50	5.50	42
5 x 2 1/2	0.50	0.31	7.50	5.50	44
5 x 3	0.50	0.48	7.50	5.50	45
5 x 4	0.50	0.50	7.50	5.50	50
6 x 2	0.55	0.31	8.00	6.00	40
6 x 3	0.55	0.48	8.00	6.00	45
6 x 4	0.55	0.52	8.00	6.00	55
6 x 5	0.55	0.50	8.00	6.00	60
8 x 4	0.60	0.52	9.00	7.00	80
8 x 5	0.60	0.50	9.00	7.00	80
8 x 6	0.60	0.55	9.00	7.00	90
10 x 4	0.68	0.52	11.00	9.00	105
10 x 6	0.68	0.55	11.00	9.00	125
10 x 8	0.68	0.60	11.00	9.00	150
12 x 6	0.75	0.55	12.00	10.00	165
12 x 8	0.75	0.60	12.00	10.00	190
12 x 10	0.75	0.68	12.00	10.00	220
14 x 6	0.66	0.55	14.00	11.50	144
14 x 8	0.66	0.60	14.00	11.50	200
14 x 10	0.66	0.68	14.00	11.50	260
14 x 12	0.66	0.75	14.00	11.50	270
16 x 6	0.70	0.55	15.00	12.50	220
16 x 8	0.70	0.60	15.00	12.50	240
16 x 10	0.70	0.68	15.00	12.50	344
16 x 12	0.70	0.75	15.00	12.50	373
16 x 14	0.70	0.66	15.00	12.50	330
18 x 6	0.75	0.55	16.50	14.00	260
18 x 8	0.75	0.60	16.50	14.00	280
18 x 10	0.75	0.68	16.50	14.00	320
18 x 12	0.75	0.75	16.50	14.00	465
18 x 14	0.75	0.66	16.50	14.00	370
18 x 16	0.75	0.70	16.50	14.00	410
20 x 6	0.80	0.55	18.00	15.50	320
20 x 8	0.80	0.60	18.00	15.50	345
20 x 10	0.80	0.68	18.00	15.50	385
20 x 12	0.80	0.75	18.00	15.50	415
20 x 14	0.80	0.66	18.00	15.50	518

(Cont.)▶

★ **CODOS 90° CON REDUCCIÓN (Cont.)**

DIA. NOM.	T	T1	A	R	PESO (LBS.)
20 x 16	0.80	0.70	18.00	15.50	533
20 x 18	0.80	0.75	18.00	15.50	515
24 x 6	0.89	0.55	22.00	18.50	480
24 x 8	0.89	0.60	22.00	18.50	505
24 x 10	0.89	0.68	22.00	18.50	545
24 x 12	0.89	0.75	22.00	18.50	795
24 x 14	0.89	0.66	22.00	18.50	837
24 x 16	0.89	0.70	22.00	18.50	635
24 x 18	0.89	0.75	22.00	18.50	675
24 x 20	0.89	0.80	22.00	18.50	740
30 x 12	1.03	0.75	25.00	21.50	840
30 x 14	1.03	0.66	25.00	21.50	860
30 x 16	1.03	0.70	25.00	21.50	900
30 x 18	1.03	0.75	25.00	21.50	940
30 x 20	1.03	0.80	25.00	21.50	1005
30 x 24	1.03	0.89	25.00	21.50	1205
36 x 12	1.15	0.75	28.00	24.50	1195
36 x 14	1.15	0.66	28.00	24.50	1215
36 x 16	1.15	0.70	28.00	24.50	1255
36 x 18	1.15	0.75	28.00	24.50	1295
36 x 20	1.15	0.80	28.00	24.50	1315
36 x 24	1.15	0.89	28.00	24.50	1520
36 x 30	1.15	1.03	28.00	24.50	1785
42 x 12	1.28	0.75	31.00	27.50	1655
42 x 14	1.28	0.66	31.00	27.50	1675
42 x 16	1.28	0.70	31.00	27.50	1715
42 x 18	1.28	0.75	31.00	27.50	1755
42 x 20	1.28	0.80	31.00	27.50	1820
42 x 24	1.28	0.89	31.00	27.50	1980
42 x 30	1.28	1.03	31.00	27.50	2245
42 x 36	1.28	1.15	31.00	27.50	2600
48 x 12	1.42	0.75	34.00	30.50	2175
48 x 14	1.42	0.66	34.00	30.50	2195
48 x 16	1.42	0.70	34.00	30.50	2235
48 x 18	1.42	0.75	34.00	30.50	2275
48 x 20	1.42	0.80	34.00	30.50	2340
48 x 24	1.42	0.89	34.00	30.50	2500
48 x 30	1.42	1.03	34.00	30.50	3000
48 x 36	1.42	1.15	34.00	30.50	3115
48 x 42	1.42	1.28	34.00	30.50	3580
54 x 12	0.90	0.75	39.00	35.29	1990
54 x 14	0.90	0.66	39.00	35.29	2015
54 x 16	0.90	0.70	39.00	35.29	2055
54 x 18	0.90	0.75	39.00	35.29	2095
54 x 20	0.90	0.80	39.00	35.29	2160
54 x 24	0.90	0.89	39.00	35.29	2320
54 x 30	0.90	0.90	39.00	35.29	2585
54 x 36	0.90	0.90	39.00	35.29	2980
54 x 42	0.90	0.90	39.00	35.29	3395
54 x 48	0.90	0.90	39.00	35.29	3565



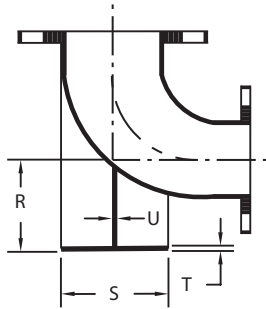

Base por debajo de Extremo Grande

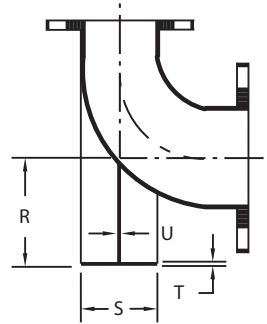

Base por debajo de Extremo Pequeño

Dimensiones de Base ver pg. 41

★ CODOS 90° CON REDUCCIÓN CON BASE					
DIA. NOM.	R	S	T	U	PESO (LBS.)
4 x 3	5.50	6.00	0.62	0.50	45
5 x 4	6.25	7.00	0.69	0.62	68
6 x 3	7.00	7.00	0.69	0.62	65
6 x 4	7.00	7.00	0.69	0.62	75
6 x 5	7.00	7.00	0.69	0.62	80
8 x 4	8.38	9.00	0.94	0.88	120
8 x 6	8.38	9.00	0.94	0.88	130
10 x 6	9.75	9.00	0.94	0.88	170
10 x 8	9.75	9.00	0.94	0.88	195
12 x 6	11.25	11.00	1.00	1.00	230
12 x 8	11.25	11.00	1.00	1.00	255
12 x 10	11.25	11.00	1.00	1.00	285
14 x 6	12.50	11.00	1.00	1.00	214
14 x 8	12.50	11.00	1.00	1.00	270
14 x 10	12.50	11.00	1.00	1.00	310
14 x 12	12.50	11.00	1.00	1.00	340
16 x 6	13.75	11.00	1.00	1.00	295
16 x 8	13.75	11.00	1.00	1.00	315
16 x 10	13.75	11.00	1.00	1.00	355
16 x 12	13.75	11.00	1.00	1.00	385
16 x 14	13.75	11.00	1.00	1.00	405
18 x 6	15.00	13.50	1.12	1.12	375
18 x 8	15.00	13.50	1.12	1.12	395
18 x 10	15.00	13.50	1.12	1.12	435
18 x 12	15.00	13.50	1.12	1.12	465
18 x 14	15.00	13.50	1.12	1.12	485
18 x 16	15.00	13.50	1.12	1.12	525
20 x 6	16.00	13.50	1.12	1.12	440
20 x 8	16.00	13.50	1.12	1.12	465
20 x 10	16.00	13.50	1.12	1.12	505
20 x 12	16.00	13.50	1.12	1.12	535
20 x 14	16.00	13.50	1.12	1.12	555
20 x 16	16.00	13.50	1.12	1.12	595
20 x 18	16.00	13.50	1.12	1.12	635
24 x 6	18.50	13.50	1.12	1.12	610
24 x 8	18.50	13.50	1.12	1.12	635
24 x 10	18.50	13.50	1.12	1.12	675
24 x 12	18.50	13.50	1.12	1.12	705
24 x 14	18.50	13.50	1.12	1.12	725
24 x 16	18.50	13.50	1.12	1.12	765
24 x 18	18.50	13.50	1.12	1.12	805

★ CODOS 90° CON REDUCCIÓN CON BASE (Cont.)					
DIA. NOM.	R	S	T	U	PESO (LBS.)
24 x 20	18.50	13.50	1.12	1.12	870
30 x 12	23.00	16.00	1.19	1.15	1030
30 x 14	23.00	16.00	1.19	1.15	1050
30 x 16	23.00	16.00	1.19	1.15	1090
30 x 18	23.00	16.00	1.19	1.15	1130
30 x 20	23.00	16.00	1.19	1.15	1195
30 x 24	23.00	16.00	1.19	1.15	1355
36 x 12	26.00	19.00	1.25	1.15	1445
36 x 14	26.00	19.00	1.25	1.15	1465
36 x 16	26.00	19.00	1.25	1.15	1505
36 x 18	26.00	19.00	1.25	1.15	1545
36 x 20	26.00	19.00	1.25	1.15	1610
36 x 24	26.00	19.00	1.25	1.15	1770
36 x 30	26.00	19.00	1.25	1.15	2035
42 x 12	30.00	23.50	1.44	1.28	2065
42 x 14	30.00	23.50	1.44	1.28	2085
42 x 16	30.00	23.50	1.44	1.28	2125
42 x 18	30.00	23.50	1.44	1.28	2165
42 x 20	30.00	23.50	1.44	1.28	2230
42 x 24	30.00	23.50	1.44	1.28	2390
42 x 30	30.00	23.50	1.44	1.28	2655
42 x 36	30.00	23.50	1.44	1.28	3010
48 x 12	34.00	25.00	1.56	1.42	2690
48 x 14	34.00	25.00	1.56	1.42	2710
48 x 16	34.00	25.00	1.56	1.42	2750
48 x 18	34.00	25.00	1.56	1.42	2790
48 x 20	34.00	25.00	1.56	1.42	2855
48 x 24	34.00	25.00	1.56	1.42	3015
48 x 30	34.00	25.00	1.56	1.42	3280
48 x 36	34.00	25.00	1.56	1.42	3630
48 x 42	34.00	25.00	1.56	1.42	4095
54 x 12	38.00	27.50	1.69	1.55	2665
54 x 14	38.00	27.50	1.69	1.55	2690
54 x 16	38.00	27.50	1.69	1.55	2730
54 x 18	38.00	27.50	1.69	1.55	2770
54 x 20	38.00	27.50	1.69	1.55	2835
54 x 24	38.00	27.50	1.69	1.55	2995
54 x 30	38.00	27.50	1.69	1.55	3260
54 x 36	38.00	27.50	1.69	1.55	3615
54 x 42	38.00	27.50	1.69	1.55	4070
54 x 48	38.00	27.50	1.69	1.55	4240

(Cont.)➔

★No Incluido en AWWA C110

REV.10.01

STAR PIPE PRODUCTS - División América Latina



4018 Westhollow Parkway | Houston, Texas 77079
+1 281 558 3000 (tel) +1 281 558 9000 (fax)

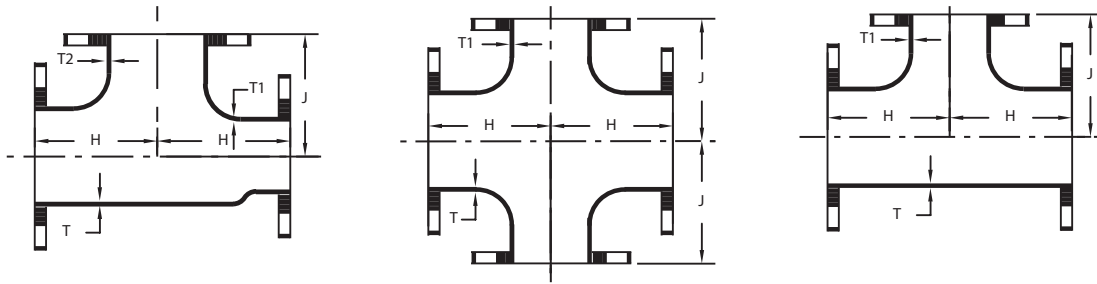

TEES Y CRUCES								
DIA. NOM.	T	T1	T2	H	J	PESO (LBS.)		
						TEE	CRUZ	
★ 1 ½ x 1 ½ x 2	0.31	0.31	0.31	4.50	4.50	15	---	
★ 2 x 1 ½ x 1 ½	0.31	0.31	0.31	4.50	4.50	16	---	
★ 2 x 2	0.31	0.31	---	4.50	4.50	20	---	
★ 2 ½ x 2 x 2	0.31	0.31	0.31	5.00	5.00	27	---	
★ 2 ½ x 2 x 2 ½	0.31	0.31	0.31	5.00	5.00	28	---	
★ 2 ½ x 1	0.31	0.31	---	5.00	5.00	25	---	
★ 2 ½ x 1 ½	0.31	0.31	---	5.00	5.00	26	---	
★ 2 ½ x 2 ½	0.31	0.31	---	5.00	5.00	30	---	
★ 3 x 1	0.48	0.31	---	5.50	5.50	32	---	
★ 3 x 1 ½	0.48	0.31	---	5.50	5.50	33	---	
★ 3 x 2	0.48	0.31	---	5.50	5.50	35	45	
★ 3 x 2 ½	0.48	0.31	---	5.50	5.50	36	---	
★ 3 x 3	0.48	0.48	---	5.50	5.50	40	50	
★ 4 x 3 x 3	0.52	0.48	0.48	6.50	5.50	55	---	
★ 4 x 2	0.52	0.31	---	6.50	6.50	50	60	
★ 4 x 2 ½	0.52	0.31	---	6.50	6.50	56	65	
★ 4 x 3	0.52	0.48	---	6.50	6.50	60	70	
★ 4 x 4	0.52	0.52	---	6.50	6.50	65	80	
★ 4 x 4 x 5	0.50	0.50	0.50	7.50	7.50	75	---	
★ 4 x 4 x 6	0.52	0.52	0.55	8.00	8.00	90	---	
★ 5 x 2 ½	0.50	0.31	---	7.50	7.50	73	---	
★ 5 x 4	0.50	0.50	---	7.50	7.50	77	---	
★ 5 x 5	0.50	0.50	---	7.50	7.50	80	---	
★ 5 x 5 x 6	0.50	0.50	0.55	8.00	8.00	87	---	
★ 6 x 3 x 5	0.55	0.48	0.50	8.00	8.00	81	---	
★ 6 x 4 x 4	0.55	0.52	0.52	8.00	8.00	85	---	
★ 6 x 4 x 5	0.55	0.50	0.50	8.00	8.00	85	---	
★ 6 x 4 x 6	0.55	0.52	0.55	8.00	8.00	90	---	
★ 6 x 5 x 2 ½	0.55	0.50	0.31	8.00	8.00	73	---	
★ 6 x 5 x 3	0.55	0.50	0.48	8.00	8.00	81	---	
★ 6 x 5 x 5	0.55	0.50	0.50	8.00	8.00	87	---	
★ 6 x 2	0.55	0.31	---	8.00	8.00	82	90	
★ 6 x 2 ½	0.55	0.31	---	8.00	8.00	84	---	
★ 6 x 3	0.55	0.48	---	8.00	8.00	85	95	
★ 6 x 4	0.55	0.52	---	8.00	8.00	90	110	
★ 6 x 5	0.55	0.50	---	8.00	8.00	91	---	
★ 6 x 6	0.55	0.55	---	8.00	8.00	95	120	
★ 6 x 6 x 8	0.55	0.55	0.60	9.00	9.00	140	---	
★ 8 x 4 x 8	0.60	0.52	0.60	9.00	9.00	138	---	
★ 8 x 5 x 4	0.60	0.50	0.50	9.00	9.00	126	---	
★ 8 x 6 x 4	0.60	0.55	0.52	9.00	9.00	130	---	
★ 8 x 6 x 6	0.60	0.55	0.55	9.00	9.00	135	---	

(Cont.)➤

TEES Y CRUCES (Cont.)								
DIA. NOM.	T	T1	T2	H	J	PESO (LBS.)		
						TEE	CRUZ	
★ 8 x 6 x 8	0.60	0.55	0.60	9.00	9.00	145	---	
★ 8 x 2 ½	0.60	0.31	---	9.00	9.00	128	---	
★ 8 x 3	0.60	0.48	---	9.00	9.00	130	140	
★ 8 x 4	0.60	0.52	---	9.00	9.00	140	155	
★ 8 x 5	0.60	0.50	---	9.00	9.00	144	---	
★ 8 x 6	0.60	0.55	---	9.00	9.00	145	165	
★ 8 x 8	0.60	0.60	---	9.00	9.00	155	195	
★ 8 x 8 x 10	0.60	0.60	0.68	11.00	11.00	260	---	
★ 8 x 8 x 12	0.60	0.60	0.75	12.00	12.00	310	---	
★ 10 x 4 x 10	0.68	0.52	0.68	11.00	11.00	250	---	
★ 10 x 6 x 4	0.68	0.55	0.52	11.00	11.00	195	---	
★ 10 x 6 x 6	0.68	0.55	0.55	11.00	11.00	200	---	
★ 10 x 6 x 10	0.68	0.55	0.68	11.00	11.00	255	---	
★ 10 x 8 x 6	0.68	0.60	0.55	11.00	11.00	210	---	
★ 10 x 8 x 8	0.68	0.60	0.60	11.00	11.00	220	---	
★ 10 x 8 x 10	0.68	0.60	0.68	11.00	11.00	265	---	
★ 10 x 2	0.68	0.31	---	11.00	11.00	199	---	
★ 10 x 3	0.68	0.48	---	11.00	11.00	201	---	
★ 10 x 4	0.68	0.52	---	11.00	11.00	205	220	
★ 10 x 5	0.68	0.50	---	11.00	11.00	211	---	
★ 10 x 6	0.68	0.55	---	11.00	11.00	215	240	
★ 10 x 8	0.68	0.60	---	11.00	11.00	225	265	
★ 10 x 10	0.68	0.68	---	11.00	11.00	270	330	
★ 10 x 10 x 12	0.68	0.68	0.75	12.00	12.00	355	---	
★ 10 x 10 x 14	0.68	0.68	0.66	14.00	14.00	375	---	
★ 12 x 6 x 6	0.75	0.55	0.55	12.00	12.00	325	---	
★ 12 x 6 x 8	0.75	0.55	0.60	12.00	12.00	345	---	
★ 12 x 8 x 6	0.75	0.60	0.55	12.00	12.00	340	---	
★ 12 x 8 x 8	0.75	0.60	0.60	12.00	12.00	290	---	
★ 12 x 8 x 12	0.75	0.60	0.75	12.00	12.00	365	---	
★ 12 x 10 x 6	0.75	0.68	0.55	12.00	12.00	375	---	
★ 12 x 10 x 8	0.75	0.68	0.60	12.00	12.00	380	---	
★ 12 x 10 x 10	0.75	0.68	0.68	12.00	12.00	345	---	
★ 12 x 10 x 12	0.75	0.68	0.75	12.00	12.00	370	---	
★ 12 x 4	0.75	0.52	---	12.00	12.00	290	310	
★ 12 x 5	0.75	0.50	---	12.00	12.00	291	---	
★ 12 x 6	0.75	0.55	---	12.00	12.00	295	320	
★ 12 x 8	0.75	0.60	---	12.00	12.00	310	345	
★ 12 x 10	0.87	0.80	---	12.00	12.00	360	415	
★ 12 x 12	0.87	0.87	---	12.00	12.00	385	460	
★ 14 x 4	0.66	0.52	---	14.00	14.00	370	---	
★ 14 x 6	0.66	0.55	---	14.00	14.00	375	400	

(Cont.)➤

★No Incluido en AWWA C110

REV.10.01

STAR PIPE PRODUCTS - División América Latina

4018 Westhollow Parkway | Houston, Texas 77079
+1 281 558 3000 (tel) +1 281 558 9000 (fax)

www.starpipeproducts.com



TEES Y CRUCES (Cont.)

DIA. NOM.	T	T1	T2	H	J	PESO (LBS.)	
						TEE	CRUZ
14 x 8	0.66	0.60	---	14.00	14.00	390	425
14 x 10	0.66	0.68	---	14.00	14.00	400	460
14 x 12	0.66	0.75	---	14.00	14.00	425	505
14 x 14	0.66	0.66	---	14.00	14.00	435	530
★ 16 x 4	0.70	0.52	---	15.00	15.00	460	---
16 x 6	0.70	0.55	---	15.00	15.00	465	490
16 x 8	0.70	0.60	---	15.00	15.00	475	520
16 x 10	0.70	0.68	---	15.00	15.00	495	555
16 x 12	0.70	0.75	---	15.00	15.00	520	605
16 x 14	0.70	0.66	---	15.00	15.00	585	620
16 x 16	0.70	0.70	---	15.00	15.00	550	665
18 x 6	0.75	0.55	---	13.00	15.50	480	505
18 x 8	0.75	0.60	---	13.00	15.50	495	535
18 x 10	0.75	0.68	---	13.00	15.50	510	560
18 x 12	0.75	0.75	---	13.00	15.50	535	610
18 x 14	0.75	0.66	---	16.50	16.50	630	720
18 x 16	0.75	0.70	---	16.50	16.50	650	765
18 x 18	0.75	0.75	---	16.50	16.50	665	795
20 x 6	0.80	0.55	---	14.00	17.00	610	635
20 x 8	0.80	0.60	---	14.00	17.00	620	665
20 x 10	0.80	0.68	---	14.00	17.00	635	685
20 x 12	0.80	0.75	---	14.00	17.00	660	735
20 x 14	0.80	0.66	---	14.00	17.00	665	745
20 x 16	0.80	0.70	---	18.00	18.00	810	915
20 x 18	0.80	0.75	---	18.00	18.00	820	945
20 x 20	0.80	0.80	---	18.00	18.00	885	1015
24 x 6	0.89	0.55	---	15.00	19.00	845	875
24 x 8	0.89	0.60	---	15.00	19.00	860	895
24 x 10	0.89	0.68	---	15.00	19.00	880	930
24 x 12	0.89	0.75	---	15.00	19.00	890	960
24 x 14	0.89	0.66	---	15.00	19.00	900	975
24 x 16	0.89	0.70	---	15.00	19.00	915	1010
24 x 18	0.89	0.75	---	22.00	22.00	1220	1365
24 x 20	0.89	0.80	---	22.00	22.00	1255	1430
24 x 24	0.89	0.89	---	22.00	22.00	1330	1570
★ 30 x 6	1.03	0.55	---	18.00	23.00	1725	---
★ 30 x 8	1.03	0.60	---	18.00	23.00	1460	---
★ 30 x 10	1.03	0.68	---	18.00	23.00	1470	---
30 x 12	1.03	0.75	---	18.00	23.00	1490	1565
30 x 14	1.03	0.66	---	18.00	23.00	1490	1570
30 x 16	1.03	0.70	---	18.00	23.00	1505	1605
30 x 18	1.03	0.75	---	18.00	23.00	1515	1615
30 x 20	1.03	0.80	---	18.00	23.00	1540	1670
30 x 24	1.03	0.89	---	25.00	25.00	2025	2245
30 x 30	1.03	1.03	---	25.00	25.00	2150	2500
★ 36 x 8	1.15	0.60	---	20.00	26.00	2140	---
★ 36 x 10	1.15	0.68	---	20.00	26.00	2150	---
36 x 12	1.15	0.75	---	20.00	26.00	2170	2240
36 x 14	1.15	0.66	---	20.00	26.00	2175	2240
36 x 16	1.15	0.70	---	20.00	26.00	2185	2270
36 x 18	1.15	0.75	---	20.00	26.00	2190	2280
36 x 20	1.15	0.80	---	20.00	26.00	2210	2325
36 x 24	1.15	0.89	---	20.00	26.00	2255	2405
★ 36 x 24 x 24	1.15	0.89	0.89	28.00	28.00	2670	---
36 x 30	1.15	1.03	---	28.00	28.00	3000	3300
36 x 36	1.15	1.15	---	28.00	28.00	3160	3620
★ 36 x 30 x 30	1.15	1.03	1.03	28.00	28.00	2885	---

(Conf.)➔

TEES Y CRUCES (Cont.)

DIA. NOM.	T	T1	T2	H	J	PESO (LBS.)	
						TEE	CRUZ
★ 36 x 36 x 48	1.15	1.15	1.42	34.00	34.00	4360	---
42 x 12	1.28	0.75	---	23.00	30.00	3165	3240
42 x 14	1.28	0.66	---	23.00	30.00	3170	3240
42 x 16	1.28	0.70	---	23.00	30.00	3180	3270
42 x 18	1.28	0.75	---	23.00	30.00	3185	3275
42 x 20	1.28	0.80	---	23.00	30.00	3205	3320
42 x 24	1.28	0.89	---	23.00	30.00	3245	3395
42 x 30	1.28	1.03	---	31.00	31.00	4125	4375
42 x 36	1.78	1.58	---	31.00	31.00	5360	5720
42 x 42	1.78	1.78	---	31.00	31.00	5580	6155
48 x 12	1.42	0.75	---	26.00	34.00	4315	4390
48 x 14	1.42	0.66	---	26.00	34.00	4315	4385
48 x 16	1.42	0.70	---	26.00	34.00	4330	4415
48 x 18	1.42	0.75	---	26.00	34.00	4330	4420
48 x 20	1.42	0.80	---	26.00	34.00	4350	4460
48 x 24	1.42	0.89	---	26.00	34.00	4385	4535
48 x 30	1.42	1.03	---	26.00	34.00	4455	4670
48 x 36	1.42	1.15	---	34.00	34.00	5555	5880
48 x 42	1.96	1.78	---	34.00	34.00	7195	7630
48 x 48	1.96	1.96	---	34.00	34.00	7385	8005
★ 54 x 12	1.05	0.75	---	29.00	37.00	4435	4575
★ 54 x 14	1.05	0.66	---	29.00	37.00	4435	4575
★ 54 x 16	1.05	0.70	---	29.00	37.00	4450	4605
★ 54 x 18	1.05	0.75	---	29.00	37.00	4460	4625
★ 54 x 20	1.05	0.80	---	29.00	37.00	4480	4665
★ 54 x 24	1.05	0.89	---	29.00	37.00	4515	4700
★ 54 x 30	1.05	0.72	---	31.00	37.00	4615	4800
★ 54 x 36	1.05	0.77	---	31.00	37.00	4695	4950
★ 54 x 42	1.05	0.88	---	39.00	39.00	5740	6210
★ 54 x 48	1.05	0.94	---	39.00	39.00	5850	6425
★ 54 x 54	1.05	1.05	---	39.00	39.00	6025	6780
★ 60 x 36	1.10	0.77	---	33.00	42.00	6015	6330
★ 64 x 42	1.16	0.88	---	48.00	45.00	9610	10085
★ 64 x 64	1.16	1.16	---	48.00	48.00	10995	12855

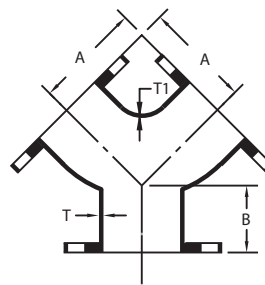

★ **"Y" 90°**

DIA. NOM.	T	T1	A	B	PESO (LBS.)
4 x 4 x 4	0.52	0.52	6.50	3.00	50
6 x 4 x 4	0.55	0.52	8.00	3.50	75
6 x 6 x 6	0.55	0.55	8.00	3.50	80
8 x 6 x 6	0.60	0.55	9.00	4.50	120
8 x 8 x 8	0.60	0.60	9.00	4.50	125
10 x 8 x 8	0.68	0.60	11.00	5.00	155
12 x 12 x 12	0.75	0.75	12.00	5.50	300

★ No Incluido en AWWA C110

REV.10.01



STAR PIPE PRODUCTS - División América Latina

4018 Westhollow Parkway | Houston, Texas 77079
+1 281 558 3000 (tel) +1 281 558 9000 (fax)

www.starpipeproducts.com

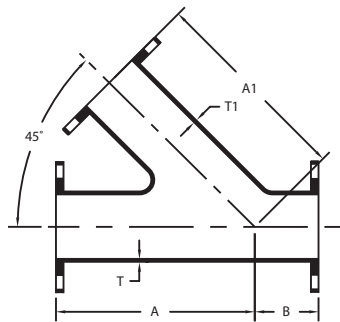

★ "Y" LATERALES 45°

DIA. NOM.	T	T1	A	A1	B	PESO (LBS.)
3 x 3	0.48	0.48	10.00	10.00	3.00	45
4 x 3	0.52	0.48	12.00	12.00	3.00	65
4 x 4	0.52	0.52	12.00	12.00	3.00	75
6 x 4	0.55	0.52	14.50	14.50	3.50	105
6 x 6	0.55	0.55	14.50	14.50	3.50	120
8 x 4	0.60	0.52	17.50	17.50	4.50	165
8 x 6	0.60	0.55	17.50	17.50	4.50	175
8 x 8	0.60	0.60	17.50	17.50	4.50	200
10 x 4	0.68	0.52	20.50	20.50	5.00	240
10 x 6	0.68	0.55	20.50	20.50	5.00	250
10 x 8	0.68	0.60	20.50	20.50	5.00	335
10 x 10	0.68	0.68	20.50	20.50	5.00	335
12 x 4	0.75	0.52	24.50	24.50	5.50	350
12 x 6	0.75	0.55	24.50	24.50	5.50	427
12 x 8	0.75	0.60	24.50	24.50	5.50	452
12 x 10	0.75	0.68	24.50	24.50	5.50	420
12 x 12	0.75	0.75	24.50	24.50	5.50	515
14 x 6	0.66	0.55	27.00	27.00	6.00	475
14 x 8	0.66	0.60	27.00	27.00	6.00	500
14 x 10	0.66	0.68	27.00	27.00	6.00	525
14 x 12	0.66	0.75	27.00	27.00	6.00	570
14 x 14	0.66	0.66	27.00	27.00	6.00	605
16 x 6	0.70	0.55	30.00	30.00	6.50	620
16 x 8	0.70	0.60	30.00	30.00	6.50	645
16 x 10	0.70	0.68	30.00	30.00	6.50	736
16 x 12	0.70	0.75	30.00	30.00	6.50	792
16 x 14	0.70	0.66	30.00	30.00	6.50	755
16 x 16	0.70	0.70	30.00	30.00	6.50	805
18 x 8	0.75	0.60	32.00	32.00	7.00	780
18 x 10	0.75	0.68	32.00	32.00	7.00	810
18 x 12	0.75	0.75	32.00	32.00	7.00	850
18 x 14	0.75	0.66	32.00	32.00	7.00	885
18 x 16	0.75	0.70	32.00	32.00	7.00	935
18 x 18	0.75	0.75	32.00	32.00	7.00	980
20 x 10	0.80	0.68	35.00	35.00	8.00	1025
20 x 12	0.80	0.75	35.00	35.00	8.00	1065
20 x 14	0.80	0.66	35.00	35.00	8.00	1110
20 x 16	0.80	0.70	35.00	35.00	8.00	1155
20 x 20	0.80	0.80	35.00	35.00	8.00	1265
24 x 8	0.89	0.60	40.50	40.50	9.00	1425

(Cont.)➔

★ "Y" LATERALES 45° (Cont.)

DIA. NOM.	T	T1	A	A1	B	PESO (LBS.)
24 x 10	0.89	0.68	40.50	40.50	9.00	1460
24 x 12	0.89	0.75	40.50	40.50	9.00	1550
24 x 14	0.89	0.66	40.50	40.50	9.00	1560
24 x 16	0.89	0.70	40.50	40.50	9.00	1615
24 x 18	0.89	0.75	40.50	40.50	9.00	1680
24 x 20	0.89	0.80	40.50	40.50	9.00	1750
24 x 24	0.89	0.89	40.50	40.50	9.00	1905
30 x 12	1.03	0.75	49.00	49.00	10.00	2545
30 x 14	1.03	0.66	49.00	49.00	10.00	2590
30 x 16	1.03	0.70	49.00	49.00	10.00	2645
30 x 18	1.03	0.75	49.00	49.00	10.00	2690
30 x 20	1.03	0.80	49.00	49.00	10.00	2760
30 x 24	1.03	0.89	49.00	49.00	10.00	2915
30 x 30	1.03	1.03	49.00	49.00	10.00	3225
36 x 12	1.15	0.75	60.00	60.00	19.50	4490
36 x 14	1.15	0.66	60.00	60.00	19.50	4545
36 x 16	1.15	0.70	60.00	60.00	19.50	4600
36 x 18	1.15	0.75	60.00	60.00	19.50	4670
36 x 20	1.15	0.80	60.00	60.00	19.50	4750
36 x 24	1.15	0.89	60.00	60.00	19.50	4920
36 x 30	1.15	1.03	60.00	60.00	19.50	5255
36 x 36	1.15	1.15	60.00	60.00	19.50	5740
42 x 20	1.28	0.80	60.00	60.00	11.75	6680
42 x 24	1.28	0.89	60.00	60.00	11.75	6850
42 x 30	1.28	1.03	63.00	63.00	11.75	7185
42 x 36	1.78	1.58	66.00	66.00	12.00	7670
42 x 42	1.78	1.78	71.00	71.00	15.00	9185
48 x 18	1.96	0.96	65.00	65.00	9.00	7000
48 x 24	1.42	0.89	64.00	64.00	5.00	8695
48 x 30	1.42	1.03	63.00	68.00	9.00	5573
48 x 36	1.42	1.15	72.00	72.00	7.00	9515
48 x 42	1.96	1.78	77.00	77.00	16.00	11030
48 x 48	1.96	1.96	77.00	77.00	16.00	12115
54 x 24	1.05	0.89	67.00	67.00	5.00	6220
54 x 30	1.05	0.72	72.00	72.00	9.00	7478
54 x 36	1.05	0.77	76.00	76.00	9.00	7600
54 x 42	1.05	0.88	81.00	81.00	14.00	8930
54 x 48	1.05	0.94	86.00	86.00	18.00	9480
54 x 54	1.05	1.05	70.00	90.00	20.00	11780
60 x 30	1.67	1.03	76.00	76.00	5.00	9045



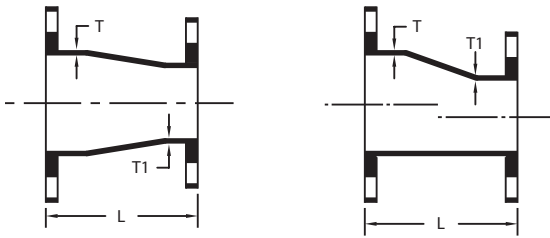

REDUCCIONES: CONCENTRICO Y EXCENTRICO

DIA. NOM.	T	T1	L	PESO (LBS.)
★ 2 x 1 1/2	0.31	0.31	5.50	10
★ 2 1/2 x 2	0.31	0.31	5.50	14
★ 3 x 2	0.48	0.31	6.00	16
★ 3 x 2 1/2	0.48	0.31	6.00	21
★ 4 x 2	0.52	0.31	7.00	25
★ 4 x 2 1/2	0.52	0.31	7.00	28
★ 4 x 3	0.52	0.48	7.00	30
★ 5 x 2	0.50	0.31	8.00	34
★ 5 x 2 1/2	0.50	0.31	8.00	35
★ 5 x 3	0.50	0.48	8.00	37
★ 5 x 4	0.50	0.50	8.00	41
★ 6 x 1 1/2	0.55	0.31	9.00	33
★ 6 x 2	0.55	0.31	9.00	35
★ 6 x 2 1/2	0.55	0.31	9.00	38
★ 6 x 3	0.55	0.48	9.00	40
★ 6 x 4	0.55	0.52	9.00	45
★ 6 x 5	0.55	0.52	9.00	52
★ 8 x 3	0.60	0.48	11.00	60
★ 8 x 4	0.60	0.52	11.00	65
★ 8 x 5	0.60	0.52	11.00	70
★ 8 x 6	0.60	0.55	11.00	75
★ 10 x 3	0.68	0.48	12.00	81
★ 10 x 4	0.68	0.52	12.00	85
★ 10 x 6	0.68	0.55	12.00	90
★ 10 x 8	0.68	0.60	12.00	110
★ 12 x 4	0.75	0.52	14.00	120
★ 12 x 5	0.75	0.50	14.00	126
★ 12 x 6	0.75	0.55	14.00	130
★ 12 x 8	0.75	0.60	14.00	145
★ 12 x 10	0.75	0.68	14.00	170
★ 14 x 6	0.66	0.55	16.00	155
★ 14 x 8	0.66	0.60	16.00	175
★ 14 x 10	0.66	0.68	16.00	190
★ 14 x 12	0.66	0.75	16.00	248
★ 16 x 6	0.70	0.55	18.00	190
★ 16 x 8	0.70	0.60	18.00	210
★ 16 x 10	0.70	0.68	18.00	235
★ 16 x 12	0.70	0.75	18.00	265
★ 16 x 14	0.70	0.66	18.00	280
★ 18 x 8	0.75	0.60	19.00	240
★ 18 x 10	0.75	0.68	19.00	265
★ 18 x 12	0.75	0.75	19.00	295
★ 18 x 14	0.75	0.66	19.00	310
★ 18 x 16	0.75	0.70	19.00	340
★ 20 x 8	0.80	0.60	20.00	290
★ 20 x 10	0.80	0.68	20.00	310
★ 20 x 12	0.80	0.75	20.00	345
★ 20 x 14	0.80	0.66	20.00	355

(Cont.)➔

REDUCCIONES: CONCENTRICO Y EXCENTRICO (Cont.)

DIA. NOM.	T	T1	L	PESO (LBS.)
★ 20 x 16	0.80	0.70	20.00	390
★ 20 x 18	0.80	0.75	20.00	410
★ 24 x 10	0.89	0.68	24.00	460
★ 24 x 12	0.89	0.75	24.00	480
★ 24 x 14	0.89	0.66	24.00	490
★ 24 x 16	0.89	0.70	24.00	525
★ 24 x 18	0.89	0.75	24.00	550
★ 24 x 20	0.89	0.80	24.00	590
★ 30 x 8	1.03	0.60	30.00	700
★ 30 x 12	1.03	0.75	30.00	730
★ 30 x 14	1.03	0.66	30.00	745
★ 30 x 16	1.03	0.70	30.00	770
★ 30 x 18	1.03	0.75	30.00	810
★ 30 x 20	1.03	0.80	30.00	870
★ 30 x 24	1.03	0.89	30.00	970
★ 36 x 16	1.15	0.70	36.00	1105
★ 36 x 20	1.15	0.80	36.00	1230
★ 36 x 24	1.15	0.89	36.00	1345
★ 36 x 30	1.15	1.03	36.00	1555
★ 42 x 20	1.28	0.80	42.00	1712
★ 42 x 24	1.28	0.89	42.00	1820
★ 42 x 30	1.28	1.03	42.00	2060
★ 42 x 36	1.28	1.15	42.00	2550
★ 48 x 30	1.42	1.03	48.00	2625
★ 48 x 36	1.42	1.15	48.00	2950
★ 48 x 42	1.42	1.28	48.00	3320
★ 54 x 30	0.90	0.61	32.00	1625
★ 54 x 36	0.90	0.66	28.00	1680
★ 54 x 42	0.90	0.76	35.00	1800
★ 54 x 48	0.90	0.80	18.00	1695
★ 60 x 54	0.94	0.90	15.00	2055

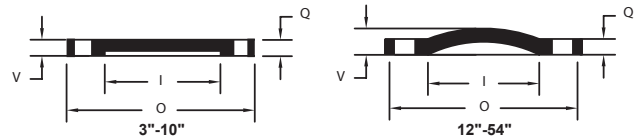

BRIDAS (CIEGA O ROSCA)

DIA. NOM.	O	Q	V	I	PESO (LBS.)
★ 3	7.50	0.75	0.69	3.00	9
★ 4	9.00	0.94	0.88	4.00	16
★ 6	11.00	1.00	0.94	6.00	25
★ 8	13.50	1.12	1.06	8.00	42
★ 10	16.00	1.19	1.12	10.00	63
★ 12	19.00	1.25	0.81	12.00	85
★ 14	21.00	1.38	0.88	14.00	120
★ 16	23.50	1.44	1.00	16.00	145
★ 18	25.00	1.56	1.06	18.00	195
★ 20	27.50	1.69	1.12	20.00	245
★ 24	32.00	1.88	1.25	24.00	370
★ 30	38.75	2.12	1.44	30.00	500
★ 36	46.00	2.38	1.62	36.00	960
★ 42	53.00	2.62	1.81	42.00	1300
★ 48	59.50	2.75	2.00	48.00	1740
★ 54	66.25	3.00	2.50	54.00	2600

Rosca conforme a ANSI/ASME B1.20.1

★No Incluido en AWWA C110

REV.10.01

STAR PIPE PRODUCTS - División América Latina

4018 Westhollow Parkway | Houston, Texas 77079
+1 281 558 3000 (tel) +1 281 558 9000 (fax)

www.starpipeproducts.com



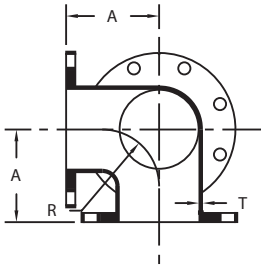

★ CODO DE 90° CON SALIDA LATERAL				
DIA. NOM.	T	A	R	PESO (LBS.)
3	0.48	5.50	4.00	35
4	0.52	6.50	4.50	60
6	0.55	8.00	6.00	95
8	0.60	9.00	7.00	145
10	0.68	11.00	9.00	240
12	0.75	12.00	10.00	345
14	0.66	14.00	11.50	478

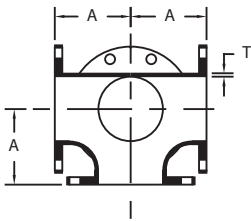

★ TEE CON SALIDA LATERAL			
DIA. NOM.	T	A	PESO (LBS.)
6 x 6	0.55	8.00	120
8 x 8	0.60	9.00	195

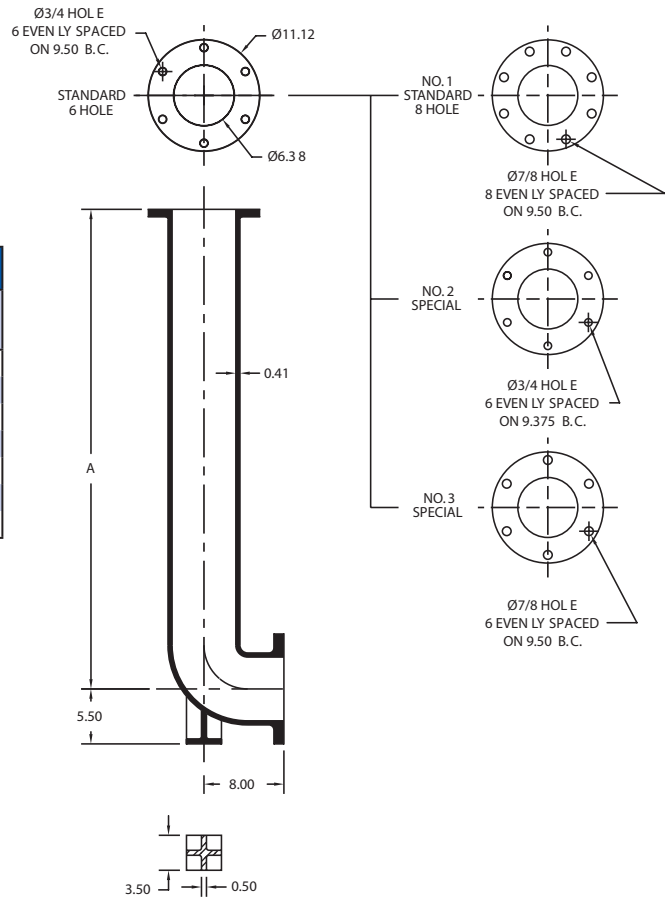

★ BURY HIDRANTES: BRIDA		
DIA. NOM.	A	PESO (LBS.)
6 x 30	30.00	112
6 x 36	36.00	126
6 x 42	42.00	139
6 x 48	48.00	155

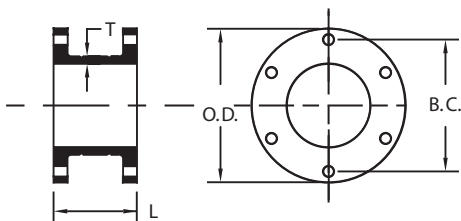

Material: Fundición de hierro gris según ASTM A 48
Extensiones incluye dos (2) ranuras para ruptura

★ EXTENSIONES PARA HIDRANTES (6 AGUJERO ESTANDAR)						
DIA. NOM.	T	DIMENSIONES			DIA. AGUJERO	PESO (LBS.)
		L	B.C.	O.D.		
6 x 6	0.56	6.00	9.50	11.12	0.75	50
6 x 12	0.56	12.00	9.50	11.12	0.75	73



★No Incluido en AWWA C110

STAR PIPE PRODUCTS - División América Latina

4018 Westhollow Parkway | Houston, Texas 77079
+1 281 558 3000 (tel) +1 281 558 9000 (fax)
www.starpipeproducts.com

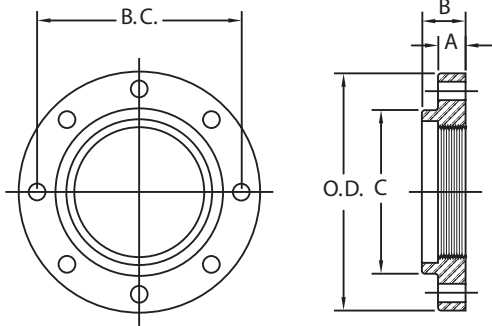

BRIDA DE HIERRO DÚCTIL ROSCABLE 125 LB. PARA TUBERÍA DE HIERRO DÚCTIL											
DIA. NOM.	DO TUBO	A	B	ROSCA LONGITUD	DO BRIDA	C	B.C.	DIA. AGUJERO	TORNILLOS (TAMAÑOS)	NO. AGUJERO	PESO (LBS.)
2	2.50	0.62	1.25	1.00	6.00	3.06	4.75	3/4	5/8 x 2 1/4	4	4
3	3.96	0.75	1.69	1.25	7.50	4.45	6.00	3/4	5/8 x 2 1/2	4	7
4	4.80	0.94	1.81	1.37	9.00	5.32	7.50	3/4	5/8 x 3	8	12
6	6.90	1.00	2.00	1.53	11.00	7.56	9.50	7/8	3/4 x 3 1/2	8	17
8	9.05	1.12	2.25	1.75	13.50	9.69	11.75	7/8	3/4 x 3 1/2	8	26
10	11.10	1.19	2.44	1.88	16.00	12.00	14.25	1	7/8 x 4	12	37
12	13.20	1.25	2.56	2.12	19.00	14.06	17.00	1	7/8 x 4	12	55
14	15.30	1.38	2.62	2.12	21.00	16.25	18.75	1 1/8	1 x 4 1/2	12	70
16	17.40	1.44	2.75	2.12	23.50	18.44	21.25	1 1/8	1 x 4 1/2	16	80
18	19.50	1.56	3.00	2.25	25.00	20.53	22.75	1 1/4	1 1/8 x 5	16	85
20	21.60	1.69	3.25	2.44	27.50	22.63	25.00	1 1/4	1 1/8 x 5	20	106
24	25.80	1.88	3.50	2.75	32.00	26.82	29.50	1 3/8	1 1/4 x 5 1/2	20	147
30	32.00	2.12	3.75	3.37	38.75	32.75	36.00	1 3/8	1 1/4 x 6 1/2	28	224
36	38.30	2.38	5.00	4.00	46.00	39.12	42.75	1 5/8	1 1/2 x 7	32	337
42	44.50	2.62	5.12	4.50	53.00	46.00	49.50	1 5/8	1 1/2 x 7 1/2	36	495
48	50.80	2.75	5.50	5.12	59.50	52.25	56.00	1 5/8	1 1/2 x 8	44	622
54	57.56	3.00	6.45	4.75	66.25	58.75	62.75	2	1 3/4 x 8 1/2	44	711
60	61.61	3.12	6.75	5.00	73.00	63.00	69.25	2	1 3/4 x 9	52	1038
64	65.67	3.38	7.06	5.25	80.00	67.18	76.00	2	1 3/4 x 9	52	1510

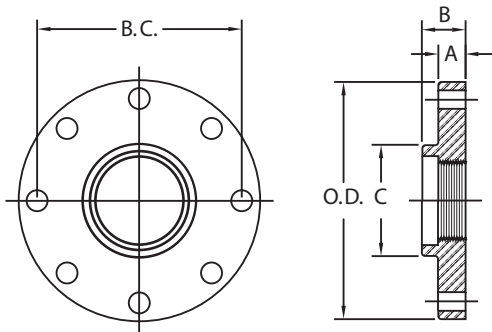

BRIDA REDUCTORA DE HIERRO DÚCTIL ROSCABLE 125 LB. PARA TUBERÍA DE HIERRO DÚCTIL											
DIA. NOM.	DO TUBO	A	B	ROSCA LONGITUD	DO BRIDA	C	B.C.	DIA. AGUJERO	TORNILLOS (TAMAÑOS)	NO. AGUJERO	PESO (LBS.)
4 x 3	3.96	0.94	1.37	0.94	9.00	4.45	7.50	3/4	5/8 x 3	8	16
6 x 4	4.80	1.00	1.56	1.00	11.00	5.32	9.50	7/8	3/4 x 3 1/2	8	25
8 x 4	4.80	1.12	1.75	1.00	13.50	5.32	11.75	7/8	3/4 x 3 1/2	8	40
8 x 6	6.90	1.12	1.75	1.16	13.50	7.56	11.75	7/8	3/4 x 3 1/2	8	35
10 x 8	9.05	1.19	2.00	1.38	16.00	9.69	14.25	1	7/8 x 4	12	50
12 x 8	9.05	1.25	2.19	1.38	19.00	9.69	17.00	1	7/8 x 4	12	85
12 x 10	11.10	1.25	2.19	1.38	19.00	12.00	17.00	1	7/8 x 4	12	65



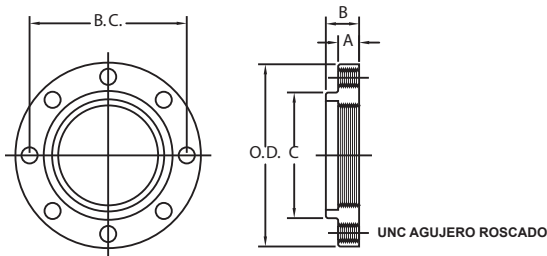

BRIDA DE HIERRO DÚCTIL ROSCABLE 125 LB. CON AGUJERO DE ROSCA PARA TUBERÍA DE HIERRO DÚCTIL										
DIA. NOM.	DO TUBO	A	B	ROSCA LONGITUD	DO BRIDA	C	B.C.	AGUJERO ROSCA (UNC-2A)	NO. AGUJERO	PESO (LBS.)
2	2.50	0.62	1.25	1.00	6.00	3.06	4.75	5/8 - 11	4	4
3	3.96	0.75	1.69	1.25	7.50	4.45	6.00	5/8 - 11	4	7
4	4.80	0.94	1.81	1.37	9.00	5.32	7.50	5/8 - 11	8	12
6	6.90	1.00	2.00	1.53	11.00	7.56	9.50	3/4 - 10	8	17
8	9.05	1.12	2.25	1.75	13.50	9.69	11.75	3/4 - 10	8	26
10	11.10	1.19	2.44	1.88	16.00	12.00	14.25	7/8 - 9	12	37
12	13.20	1.25	2.56	2.12	19.00	14.06	17.00	7/8 - 9	12	55
14	15.30	1.38	2.62	2.12	21.00	16.25	18.75	1 - 8	12	70
16	17.40	1.44	2.75	2.12	23.50	18.44	21.25	1 - 8	16	80
18	19.50	1.56	3.00	2.25	25.00	20.53	22.75	1 1/8 - 7	16	85
20	21.60	1.69	3.25	2.44	27.50	22.63	25.00	1 1/8 - 7	20	106
24	25.80	1.88	3.50	2.75	32.00	26.82	29.50	1 1/4 - 7	20	147
30	32.00	2.12	3.75	3.37	38.75	32.75	36.00	1 1/4 - 7	28	224
36	38.30	2.38	5.00	4.00	46.00	39.12	42.75	1 1/2 - 6	32	337
42	44.50	2.62	5.12	4.50	53.00	46.00	49.50	1 1/2 - 6	36	495
48	50.80	2.75	5.50	5.12	59.50	52.25	56.00	1 1/2 - 6	44	622
54	57.56	3.00	6.45	4.75	66.25	58.75	62.75	1 3/4 - 5	44	711
60	61.61	3.12	6.75	5.00	73.00	63.00	69.25	1 3/4 - 5	52	1038
64	65.67	3.38	7.06	5.25	80.00	67.18	76.00	1 3/4 - 5	52	1510

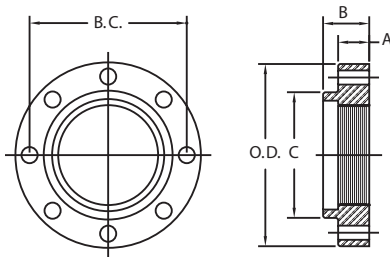

BRIDA DE HIERRO DÚCTIL ROSCABLE 250 LB. PARA TUBERÍA DE HIERRO DÚCTIL											
DIA. NOM.	DO TUBO	A	B	ROSCA LONGITUD	DO BRIDA	C	B.C.	DIA. AGUJERO	TORNILLOS (TAMAÑOS)	NO. AGUJERO	PESO (LBS.)
3	3.96	1.12	1.56	1.19	8.25	4.62	6.62	7/8	3/4 x 3 1/2	8	10
4	4.80	1.25	1.75	1.31	10.00	5.75	7.88	7/8	3/4 x 4	8	19
6	6.90	1.44	1.94	1.56	12.50	8.12	10.62	7/8	3/4 x 4	12	31
8	9.05	1.62	2.19	1.75	15.00	10.25	13.00	1	7/8 x 4 1/2	12	47
10	11.10	1.88	2.38	1.94	17.50	12.62	15.25	1 1/8	1 x 5 1/2	16	70
12	13.20	2.00	2.56	2.19	20.50	14.75	17.75	1 1/4	1 1/8 x 5 1/2	16	114
14	15.30	2.12	2.69	2.25	23.00	16.25	20.25	1 1/4	1 1/8 x 6	20	122
16	17.40	2.25	2.88	2.50	25.50	18.38	22.50	1 3/8	1 1/4 x 6 1/2	20	159
18	19.50	2.38	3.00	2.56	28.00	20.53	24.75	1 3/8	1 1/4 x 6 1/2	24	205
20	21.60	2.50	3.31	2.87	30.50	22.63	27.00	1 3/8	1 1/4 x 7	24	220
24	25.80	2.75	3.75	3.25	36.00	26.82	32.00	1 5/8	1 1/2 x 7 1/2	24	342
30	32.00	3.00	4.75	4.33	43.00	35.00	39.25	2	1 3/4 x 8 1/2	28	502
36	38.30	3.38	5.37	4.63	50.00	41.25	46.00	2 1/4	2 x 9 1/2	32	690



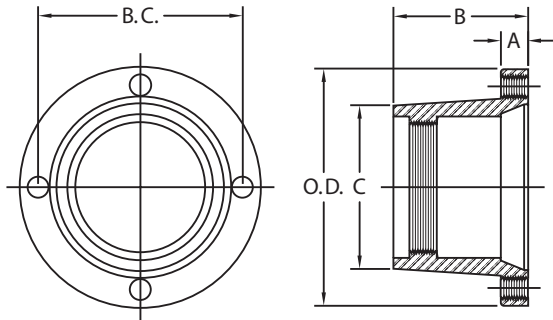

JUNTA MECANICA DE HIERRO DÚCTIL ROSCABLE PARA TUBERÍA DE HIERRO DÚCTIL

DIA. NOM.	DO TUBO	A	B	ROSCA LONGITUD	DO BRIDA	C	B.C.	AGUJERO ROSCA (UNC-2A)	NO. AGUJERO	PESO (LBS.)
3	3.96	0.94	4.12	0.94	7.69	4.50	6.19	5/8 - 11	4	11
4	4.80	1.00	4.25	1.00	9.12	5.32	7.50	3/4 - 10	4	15
6	6.90	1.06	4.43	1.16	11.12	7.56	9.50	3/4 - 10	6	22
8	9.05	1.12	4.75	1.38	13.37	9.73	11.75	3/4 - 10	6	35
10	11.10	1.19	4.87	1.50	15.69	12.06	14.00	3/4 - 10	8	46
12	13.20	1.25	5.12	1.75	17.94	14.16	16.25	3/4 - 10	8	55
14	15.30	1.31	6.50	1.87	20.31	16.25	18.75	3/4 - 10	10	94
16	17.40	1.38	6.75	2.06	22.56	18.44	21.00	3/4 - 10	12	118
18	19.50	1.44	7.00	2.25	24.83	20.53	23.25	3/4 - 10	12	125
20	21.60	1.50	7.25	2.44	27.08	22.63	25.50	3/4 - 10	14	150
24	25.80	1.62	7.50	2.75	31.58	26.82	30.00	3/4 - 10	16	235
30	32.00	1.81	9.13	3.37	39.12	32.75	36.88	1 - 8	20	375
36	38.30	2.00	9.75	4.00	46.00	39.12	43.75	1 - 8	24	500
42	44.50	2.00	10.50	4.00	53.12	46.00	50.62	1 1/4 - 7	28	735
48	50.80	2.00	11.00	4.12	60.00	52.25	57.50	1 1/4 - 7	32	940

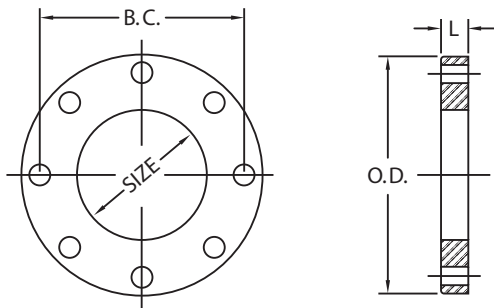

BRIDA DE RELLENO (FUNDICIÓN DE HIERRO GRIS)

DIA. NOM.	DO BRIDA	B.C.	TORNILLOS	DIA. AGUJERO	PESO (LBS.)									
					1/2	3/4	1	1 1/2	2	3	4	5	6	
3	7.50	6.00	3/4	4	5	7	9	14	18	27	36	45	54	
4	9.00	7.50	3/4	8	6	9	12	19	25	37	49	62	74	
6	11.00	9.50	7/8	8	8	12	16	24	32	48	64	81	97	
8	13.50	11.75	7/8	8	11	17	23	34	46	69	92	114	137	
10	16.00	14.25	1	12	15	22	29	44	59	88	118	147	176	
12	19.00	17.00	1	12	21	31	42	63	84	126	167	209	251	
14	21.00	18.75	1.12	12	23	35	47	70	94	141	188	235	282	
16	23.50	21.25	1.12	16	28	42	56	85	113	169	225	282	338	
18	25.00	22.75	1.25	16	28	42	56	85	113	169	225	282	338	
20	27.50	25.00	1.25	20	33	50	66	100	133	199	265	332	398	
24	32.00	29.50	1.38	20	42	63	84	126	167	251	335	419	502	
30	38.75	36.00	1.38	28	56	84	112	168	224	336	448	560	672	
36	46.00	42.75	1.63	32	75	113	150	225	300	450	601	751	901	

REV.10.01



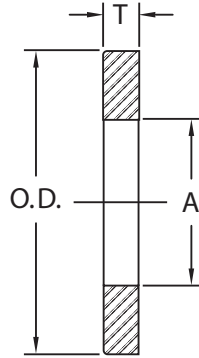
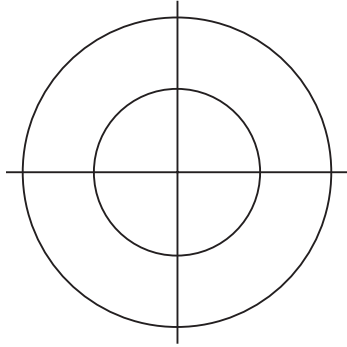

BRIDA DE ANCLA (HIERRO DÚCTIL)

DIA. NOM.	T	DO BRIDA	A	PESO (LBS.)
3	0.50	6.50	4.03	3
4	0.50	7.40	4.87	4
6	0.50	9.50	6.97	5
8	0.50	12.00	9.13	7
10	0.50	14.10	11.17	8
12	0.50	16.25	13.27	10
14	0.50	18.40	15.38	12
16	0.50	21.00	17.48	15
18	0.50	23.10	19.59	17
20	0.50	25.70	21.69	21
24	0.50	30.00	25.90	25
30	0.63	37.00	32.10	47
36	0.63	43.40	38.40	53
42	1.00	50.00	44.62	104
48	1.00	56.50	50.94	122
54	<i>{ Dimensiones disponibles bajo solitud }</i>			

PAQUETE DE ACCESORIOS PARA PIEZAS BRIDA CON 1/8" EMPAQUE (ASTM D2000 TIPO A), TORNILLOS HEX (A-307) GALVANIZADO "ZINC PLATED"

DIA. NOM.	TORNILLOS	CANT	PESO (LBS.)
1 1/2	1/2 x 2	4	1
2	5/8 x 2 1/4	4	1.4
2 1/2	5/8 x 2 1/2	4	1.8
3	5/8 x 2 1/2	4	2
4	5/8 x 3	8	3
5	3/4 x 3	8	5
6	3/4 x 3 1/2	8	5
8	3/4 x 3 1/2	8	6
10	7/8 x 4	12	12
12	7/8 x 4	12	13
14	1 x 4 1/2	12	19
16	1 x 4 1/2	16	25
18	1 1/8 x 5	16	35
20	1 1/8 x 5	20	45
24	1 1/4 x 5 1/2	20	63
30	1 1/4 x 6 1/2	28	95
36	1 1/2 x 7	32	170
42	1 1/2 x 8	36	215
48	1 1/2 x 8	44	265
54	1 3/4 x 8 1/2	44	390
60	1 3/4 x 9	52	500

